



2018 Humanitarian Health Conference

The Art of Serving

*April 12 - 13, 2018
Kansas City, Missouri*

#2018HHC

Welcome

Ours seems to be an era of remarkable self-interest. Individuals tout their personal authority while governments tout their international domination. But in reality, self-interest has been preeminent since biblical times. Contrary to self-interest is the art of serving. The 2018 Humanitarian Health Conference will call us to reconsider not simply the priority of assisting others, but also the fine skill it may require.

Thank you for joining us in amplifying the value and ability to serve with excellence. During these precious two days, learn truly useful skills, connect with like-minded friends, and explore volunteer opportunities to especially express your own art of serving.

Nicholas Comninellis

Nicholas Comninellis, MD, MPH, DIMPH
 President, Institute for International Medicine



Nicholas Comninellis



Table of Contents

Welcome	2
About INMED.....	3
Corporate Sponsors	4
Individual Sponsors.....	5
Speakers	6-9
Bookstore Hours	10
Exhibitors	12-18
Continuing Ed.	22-23
Awards	24-25
Graceway Maps	26-27
Schedule	28-29

INMED

Equipping Healthcare Professionals and Students to Serve the Forgotten

The Institute for International Medicine (INMED) exists to equip healthcare professionals and students to serve the forgotten. We are a nonprofit educational



INSTITUTE FOR
INTERNATIONAL
MEDICINE

organization that offers didactic instruction in international health, diseases of poverty, and community health development via online and in-classroom courses, as well as conferences. We also offer supervised international service-learning experiences for healthcare students and professionals at over 45 training sites in 20 low-resource countries.

Service Learning

Diploma Programs

- International Medicine & Public Health Diploma (DIMPH)
- International Nursing & Public Health Diploma (DINPH)
- International Public Health Diploma Program (DIPH)

Alumni Opportunities

- Alumni Service Program
- INMED Fellowship



Check out **inmed.us** to browse our list of international training sites.

Courses

Hybrid Courses

- International Medicine & Public Health Hybrid Course
- International Nursing & Public Health Hybrid Course
- International Public Health Hybrid Course

Online Self-Paced Courses

- Free Demo Course
- International Public Health, 2nd Ed.
- Diseases of Poverty
- International HIV Medicine
- Cross-Cultural Skills
- Disaster Management in Limited Resource Settings
- International Health Leadership
- Maternal-Newborn
- Healthcare Education
- Ultrasound for Primary Care

For more information, please visit inmed.us or contact us at:

INMED
2340 E. Meyer Blvd. Building 1 Suite # 338
Kansas City, MO 64132

E-mail: office@inmed.us
Phone: 816-444-6400
Fax: 816-444-6400

Corporate Sponsors



Butterfield Memorial Foundation

College Park Family Care Center

George Faile Foundation

Hodgdon Family Charitable Fund

Hospital Corporation of America (HCA) Midwest

Jack Hill Continuing Medical Education Foundation

Hosts



INSTITUTE FOR
INTERNATIONAL
MEDICINE



Major Donors

Troy Burns
Datcha Dorvil
Peter & Kim Greenspan
Ted & Kim Higgins
Spencer & Beckie Kerley
Mike & Sandy Searcy
David Zamierowski

Individual Sponsors

Dale Agner
Kate Alberts
Susan Aycock
Cecelia Babbott
Roger Bredehoft
Andy Bukaty
Nancy Crigger
Nancy Dye
Bill Gilbirds
Anne Goerz
Reuel Gregory
Kevin Hubbard
Juhi Kangas
Marty Kanne
Ali Khezrian
Gary Kindell
Scott Kujath
Winston Manimtim
Allan Martin
Gary McEwen

David McKinsey
Nancy Miller
David Miller
Andy Moyes
Joe Muroka
Bruce Pfuetze
Rick & Jo Randolph
Jesse Roberts
Francie Stoner
Charles Sullivan
Glenn Talboy
Rory Tompkins
Bob Tung
Larry Van Vleet
Vince Waite
Betsy Wickstrom
Audrey Williams
Julie Wood
Shormeh Yeboah

Speakers



Nicholas Comninellis, MD, MPH, DIMPH

Dr. Comninellis is President of INMED and board certified in both public health and family medicine. Nicholas trained in tropical medicine at the Walter Reed Army Institute of Research, and served four years in Shanghai, China, and Angola, Africa. Today he teaches public health at the University of Missouri-Kansas City.



Hayley Stolzle

Hayley Stolzle, MPH has over 10 years of experience in public health including experience in project management, health research, and health education initiatives in both clinical and community-based settings. Prior to her position with the CDC, Ms. Stolzle was a health promotion officer and health management capacity builder with the US Peace Corps in Tsabong, Botswana overseeing a national gender committee and multiple health education projects for the Kgalagadi South District Health Management Team.



Betsy Sutherland

Betsy Sutherland has been using her background in education and medicine to educate healthcare students and professionals on the facets of human trafficking for over three years. She received her BS in Education in 2008 and will complete her medical degree from St. Louis University School of Medicine in 2018.



Micah Flint, MPA, RN, DINPH

Micah Flint, MPA, RN, DINPH is the Chief Innovations Officer for INMED. Micah's expertise is in the fields of humanitarian relief, innovative entrepreneurship, and public health. He is the co-author of Disaster Response: Pocket Book for Volunteers, Overview of Disaster Management in Limited Resource Settings and has presented at national conferences. He is the founder of the annual INMED Humanitarian Health Conference.



Lori Clements

After living in Angola for 3 years, Lori Clements started a scholarship fund for Angolan college students encouraging them in their education—knowing that improvement of education will develop into improvement in society. During her time in Angola, her blogging on individual people resulted in life changing projects for the Blind Association. She was able to raise money to refurbish or build houses for widows, and to build store fronts for blind people to manage to create a sustainable living for their families.



Jay Grimwood

Jay Grimwood is the International Development Pastor at Graceway. Jay has led international pastoral/teacher training teams to South Korea, the Philippines, India, Nepal, and Egypt. He has also helped develop educational and humanitarian programs in Mongolia, Zambia, Japan, Taiwan, and Kurdistan.

Speakers



Elisha Katamura

Elisha Katamura serves as Outreach Pastor at Graceway. After serving as a lead pastor in Tokyo, he and his wife are back in Kansas City, building bridges with international students, immigrants, refugees, and training pastors and leaders in multiple international locations.



Fred Loper, MD

Fred Loper, MD is a primary care physician in practice since 1979 with wide experience in volunteer medical missions. He enjoys the variety of general practice and considers it an honor to care for patients. He also likes to hang out with family, backpack, bicycle, and work on his old house.



Tim Myrick, MD

Tim Myrick, MD and his family have worked in various government hospitals and mission hospitals in diverse locations in Africa and the Middle East for the past 20 years. They have learned several languages and experienced valuable opportunities for service along the way. Dr. Myrick continues to serve refugees throughout the Middle East and Africa.



Glen Talboy, MD

Glenn Talboy, MD is the Chairman of Surgery at the University of Missouri – Kansas City and the Program Director for the general surgery residency program. “I have been involved in international surgical missions for 12 years and lead author on two surgical wound care chapters entitled, ‘Essentials of Surgery.’”



Jeff Palmer

Jeff Palmer has over 20 years of hands on experience in international development at the community level. He has learned much during this time and found that people working together can accomplish amazing things. Jeff is currently CEO of BGR, a Southern Baptist relief and development organization.



Judith LeMaster, RN

Judith LeMaster, RN is a UK trained nurse and midwife. She worked in Nepal for 15 years in medical missions, the last 10 with her American physician husband and two children. Judith and her family resettled in the USA in 2000, and have most recently been working with Bhutanese refugees in Kansas City.

Speakers



Stan Augustin, MD, FACS

Stan Augustin, MD, FACS completed his General Surgery Residency at University of Missouri-Kansas City School of Medicine. He completed Surgical Critical Care fellowship training at Barnes-Jewish Hospital. He is board certified in General Surgery and Surgical Critical Care. He has completed training in complex wound care and hyperbaric treatment.



Laura Captari

Laura Captari serves with Humanitarian Disaster Institute and is pursuing her doctorate in counseling psychology at the University of North Texas. Her research investigates factors that promote resilience, post-traumatic growth, and racial reconciliation. She has worked in North Africa and Eastern Europe and is the co-author of five books.



Lawand Abdulrahman, Ph.D

Lawand Abdulrahman is a Ph.D student at KU, Law School. He serves with the UNHCR providing legal counseling for complicated refugee cases at focal point for 4 camps. The camp services include providing food, shelter, health care and security conforming to international protection standard. They are also a focal point for deportation, registration, advocacy with local authority, and promoting sustainable solutions.



Commander Carl Huffman, PA-C

Commander Carl Huffman is a certified Physician Assistant and Medical Technologist. He has worked for the FDA for the past 17 years and is currently the drug supervisor for the Pharma Division 3 group. He has deployed for Katrina and the more recent Ebola outbreak and is considered an SME in pharmaceutical regulations and quality.



Winston Manimtim, MD, DIMPH

Winston Manimtim, MD, DIMPH is a neonatologist at Children's Mercy Hospitals and Clinics. Dr. Manimtim has been teaching the American Academy of Pediatrics Helping Babies Breathe course all over the world for the past 18 years. Dr. Manimtim also has extensive international medicine and global neonatology experience.



Rick Randolph, MD

Rick Randolph, MD is the Chief Medical Officer of Heart to Heart International, based in Lenexa, KS. For the past two decades, he has provided primary care, disaster response, and public health within the US and globally. He holds a graduate certificate in Public Health in the Developing World.

Speakers



Katie Richardson, MD

Katherine Richardson, MD, is a second-year pediatric infectious diseases fellow at Children's Mercy Hospital in Kansas City, Missouri. She has been on multiple mission trips, both medical and otherwise, through medical school and residency in Pennsylvania and North Carolina, respectively. It is her passion to serve the underserved.



Nick Townley, MD

Nick Townley, MD is a 3rd-year neonatology fellow at Children's Mercy Hospital, training under the guidance of Dr. Manimtim. He is joining the faculty at Creighton Medical School and Omaha Children's Hospital starting this summer.



Tim Dunn

Tim Dunn is the senior pastor at Graceway, a cultural, ethnic, and generational diverse community. Tim has over 15 years serving in cross cultural and urban settings.



Peter Greenspan, DO

Peter Greenspan, DO is a native of Brooklyn, New York, and a graduate of the Chicago College of Osteopathic Medicine. Since 1997 this Board-certified obstetrician/gynecologist has instructed medical students and residents in the Kansas City area. Dr. Greenspan, a messianic Jew, is a recognized authority on subjects of apologetics, medical ethics and human cloning.



Joe LeMaster, MD, MPH

Joseph LeMaster, MD, MPH is an Associate Professor at the University of Kansas Medical Center. He has collaborated with INMED on the development of curricula to improve cross-cultural competence and refugee healthcare.



Don Philgreen, MD

Don Philgreen, MD has worked for Research Family Medicine Residency since 1996. He is also medical director for the LIGHT House and Rachel House ministries which assist young women who are involved in crisis pregnancy. Don's medical experience includes four years service to the Pima and Papago on the Gila River Indian Reservation. In 2004, Don was named the Missouri Family Physician of the Year by the Missouri Academy of Family Physicians.

Conference Bookstore

Located on Main Floor at the Resource Table

HOURS OF OPERATION

Thursday, 10:00 am - 4:30 pm

Friday, 10:00 am - 5:15 pm



INMED International Medicine & Public Health, 2nd

\$45.00



Disaster Response: Pocket Book for Volunteers

\$10.00

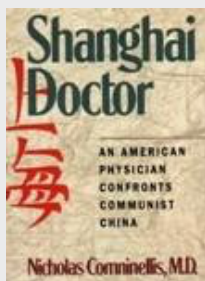

Shanghai Doctor

\$10.00

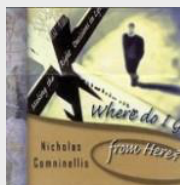

Where Do I Go From Here? Making the Right Decision

\$15.00

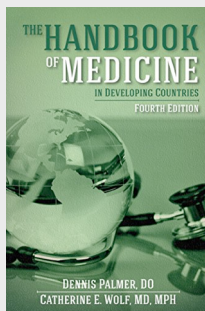

Handbook of Medicine in Developing Countries

\$35.00



INMED Shirts

\$12.00

Check the bookstore for additional items!

Early Bird Registration Available

Thursday and Friday Only

Register for the 2019 HHC

Only \$100

Purchase 2019 Registration at the Conference Bookstore
No Refunds Available

THEIR CHILDHOOD SHOULDN'T DISAPPEAR.

LET'S END THE TOXIC STRESS

THAT'S RUINING CHILDHOODS

IN THE MIDDLE EAST.

LEARN MORE ABOUT OUR NEW INITIATIVE, **SAT-7 ACADEMY**, AND TRAUMA CARE PROGRAMMING AT SAT7EDUCATION.ORG



WWW.SAT7USA.ORG



Are you prepared for your next international service trip?

INMED Hybrid Courses are designed to equip you with the unique skills to effectively serve the world's most forgotten people.

**International
Medicine & Public
Health Hybrid
Course**

10 weeks online, 2
days in-classroom

**International
Nursing & Public
Health Hybrid
Course**

10 weeks online, 2
days in-classroom

**International
Public Health
Hybrid Course**

5 weeks online, 1 day
in-classroom

2018 in-classroom locations

- Long Island, New York
- Shenyang, China
- Boston, Massachusetts
- Pittsburgh, Pennsylvania
- Kirksville, Missouri
- Kansas City, Kansas
- Glendale, California

Save 15% on a 2018 hybrid course by using the coupon code "hybrid15" when registering online

Learn more at: inmed.us/courses-info/hybrid-courses

Exhibitors

Fly For Good

www.flyforgood.com
 Anthony Hilden
 anthony@flyforgood.com
 (952) 886-7686

Booth 101



Fly For Good offers discounted international airfare for your next trip for your church or humanitarian group. Contact us at staff@flyforgood.com for a quote. We offered discounted airfare on over 35 airlines world-wide and have some of the most experienced agents in the marketplace.

Mercy and Truth

international@mercyandtruth.com
 Cynthia Moore, RN, MSN
 international@mercyandtruth.com
 (913) 942-2941

Booth 102



Stop by and visit our booth to find out what opportunities you can have to serve locally, nationally and internationally in 2018. Our mission is to seek to meet the spiritual and physical needs of the world through health care and the Gospel.

Franciscan Mission Warehouse

www.FMWarehouse.org
 Michael Straughn
 mstraughn@fmwarehouse.org
 (816) 994-2659

Booth 103



The Franciscan Mission Warehouse collects donated surplus medical equipment and supplies from Kansas City area hospitals and makes them available to support hospitals and clinics in the poorest parts of the world. In addition, FMW provides medical supplies to support local social service agencies and their clients.

SAT-7

www.sat7usa.org
 Dennis Wiens
 usa@sat7.org
 (410) 770-9807

Booth 104



SAT-7 is a Middle East and North Africa indigenous Christian broadcast media ministry. The network supports 5 channels in the major languages of the region. The ministry's mission is to build the Church through non-political and nonpartisan, biblically based programming, more than 80% of which is produced in the Middle East by Middle Easterners.

Exhibitors

Mission Nation Travel

Booth 105

www.missionnationtravel.com
 Randy Whiting
 Randy.Whiting@missionnation.com
 (954) 947-2306



Our passion for the world is at the center of our daily work as we assist faith and development travelers with their complex flight itineraries around the globe. Our team has over 265 years of combined expertise and are dedicated in creating the best itinerary, benefits and cost for your travel. Allow us to do the travel planning so you can focus on your objective.

Heart to Heart International

Booth 106

www.hearttoheart.org
 Betsy Warfield
 betsy.warfield@hearttoheart.org
 (913) 764-5200



Heart to Heart International strengthens communities through improving health access, providing humanitarian development and administering crisis relief worldwide. We engage volunteers, collaborate with partners and deploy resources to achieve this mission.

Docs Who Care

Booth 107

www.DocsWhoCare.com
 Michael Seward
 mseward@docswhocare.com
 (913) 397-7800



Docs Who Care provides physician, PA and nurse practitioner staffing in MO, KS, IA, NE, CO and WA. Consider joining our team serving rural communities a limited number of days a month, allowing for work/life balance to pursue family, medical missions, and outside interests!

MAP International

Booth 108

www.map.org
 Lo-Ann Frame
 lframe@map.org
 (912) 280-6665



MAP International is a Christian organization providing life-changing medicines and health supplies to people in need. MAP serves all people, regardless of religion, gender, race, nationality, or ethnic background. MAP International provides lifesaving medicines and medical supplies to people living in conditions of poverty. Providing health, hope and so much more.

Exhibitors

Health For India

Booth 109

www.healthforindiaus.com
 Hope Howe
 hope@healthforindiaus.com
 (913) 829-6555



Health for India was incorporated by All India Mission to continue the medical efforts that All India Mission began and further sponsor the hospital work and outreach programs for the future. Health for India serves the impoverished and unreached people groups of Northeast India through our services at Shanti Bhavan Medical Center, Community Health Partners and our Rural Medical Services team.

Dignity:Liberia

Booth 110

dignityliberia.org
 Kathi Gutierrez
 kathimgut@gmail.com
 (816) 217-8751



Dignity:Liberia is committed to bringing restoration and hope to women with fistula, and their communities, through healing, education, and prevention.

Living Room Ministries International

Booth 111

www.livngroominternational.org
 Dennis McGowan
 dennismcgowan@sbcglobal.net
 (530) 246-0693



Living Room International is a ministry to those with life threatening diseases in Kenya, Africa. We provide free palliative care to the poor and marginalized. We provide in-patient & out-patient care, physical therapy and care to at risk children. We have a 24 bed hospice on our first campus and are currently building a second campus with a 52 bed hospice, education center and mortuary services.

YWAM Ships

Booth 112

www.ywamships.net
 Susan Caddell
 susan.caddell@ywamships.net
 (808)747-4426



YWAM Ships Kona serves the needs of isolated islands. We carry volunteers and supplies, bringing compassion, hope and training to remote locations accessible only by ships. Come volunteer with us! We have exciting opportunities at Port YWAM in Kona, onboard one of our ships as crew while we sail in Papua New Guinea, Micronesia, or at our Outpost Panama.

Exhibitors

Higgins Brothers Surgicenter for Hope

Booth 113

higginsbrothersurgicenter.org
Edward Higgins
tedhig@gmail.com
(816) 830-4179



The mission of Higgins Brothers Surgicenter for Hope is to address the critical shortage of surgical facilities and train surgeons and medical staff in Haiti through the volunteer efforts of surgeons and others, and by raising financial resources to develop a long-term solution.

Collaborative for Neighborhood Transformation

Booth 114

www.neighborhoodtransformation.net
Garold Elston
gelston@neighborhoodtransformation.net
(661) 816-0169



Neighborhood Transformation is a strategy that helps churches minister in a holistic manner to people in urban poor neighborhoods. It empowers people to take responsibility for their own lives. It helps neighbors to help their neighbors and moves them from welfare and relief to empowerment.

Americares Medical Outreach

Booth 115

medicaloutreach.americares.org
Mimi Bateman
mbateman@americares.org
(203) 658-9544



Each year, Americares Medical Outreach program supports volunteer medical teams making more than 1,000 trips to approximately 80 countries with medicine, supplies and educational resources. These medical teams provide primary care, perform surgeries, respond to emergencies and strengthen local health care capacity in communities where even basic medical care is often nonexistent or inaccessible.

US Army Medical Recruiting

Booth 116

www.goarmy.com/amedd.html
Chad Agustin
chad.m.agustin.mil@mail.mil
(913) 496-1784



Here's your chance to be a part of a team that shares your commitment to teamwork and making a difference. Become a U.S. Army Health Care Professional and earn financial benefits and opportunities for repayment of qualifying school loans. What's more, you'll have access to the most advanced training, treatments and technology. To learn more, visit goarmy.com/amedd.html or call 913-469-0524.

Exhibitors

Christian Health Service Corps

Booth 117

www.healthservicecorps.org
Steve Tschoepe
steve@healthservicecorps.org
(903) 962-4000



CHSC is a ministry of Christian doctors, health professionals and health educators serving the poor long-term in places that have little or no access to healthcare. Each year, we bring compassionate, life-saving health services to hundreds of thousands of families around the world. Our doctors and health professionals are often the only access to care for young families in poor communities.

Interserve

Booth 118

www.interserveusa.org
Susan Lucasse
susan.lucasse@interserveusa.org
(800) 809-4440



Interserve is a community of Christian professionals using our skills creatively and intentionally to serve marginalized peoples in Asia and the Arab world. We long to see lives and communities transformed through encounter with Jesus and invest ourselves in humanitarian and capacity-building work. Our long history in healthcare allows us to provide mentored internships for healthcare students.

Kansas Recruitment and Retention Center

Booth 119

www.ruralhealth.kumc.edu
Sasha Randolph
srandolph2@kumc.edu
(316) 293-2649



We partner with mission-minded health care providers, Kansas employers, and stakeholders to increase access to quality health care for the people of rural and urban underserved Kansas. We do this by advancing the health care workforce through recruitment, retention, research and education.

Friends University

Booth 120

www.friends.edu
Rachel Steiner
rachel_steiner@friends.edu
(316) 295-5693



As a Christian University of Quaker heritage, Friends University equips students to honor God and serve others by integrating their intellectual, spiritual and professional lives. Our students learn inside and outside the classroom, and we assign great value to diversity of experience.

Exhibitors

Hope Family Care Center

Hfckc.org
Anne Kettler
tkettler@aol.com
(816) 861-6500

Booth 121



Hope Family Care Center (HFCC) is a faith-based family medical practice providing quality primary healthcare in Kansas City Missouri's east side. All patients are welcome including the uninsured, those with insurance, Medicaid, or Medicare. Our desire is to give dignity and Jesus' love to our patients, and to contribute to health and stability in our community through accessible primary care providers. We also provide dermatology and dietary as well as being a site for WIC one day a week.

SIM

simusa.org
Andrea Wilson
andrea.wilson@sim.org
(704) 588-4300

Booth 122



SIM Healthcare Ministries invites you to pray about joining us as we bring good news to places where Jesus is least known, through community health outreach, clinics, hospitals and beyond, joining Him to heal those broken in spirit, soul, and body. Short term, midterm, and long-term opportunities available. Visit our booth today to learn how your medical expertise can have an eternal impact.

Wheaton College Graduate School

www.wheaton.edu/graduate-school
Jennifer Carver
graduate.admissions@wheaton.edu
(630) 752-5111

Booth 123



Wheaton College Graduate School was founded in 1937 to provide further theological training and ministry skills needed to advance the cause of Christ and His kingdom. Our goal is to equip emerging leaders through a singular educational experience to go into the world and become effective influencers wherever God may call them.

Medical Missions Foundation

www.medicalmissionsfoundation.org
Todd Stettner
Todd@medicalmissionsfoundation.org
(913) 338-0343

Booth 124



Our mission is to provide surgical and medical care in underserved communities throughout the world and to positively impact the lives of children and their families.

Exhibitors

Research Family Medicine Residency

Booth 125

researchresidency.com
Beverly Cline
Beverly.Cline@Hcamidwest.com
(816) 276-7650



Research Family Medicine Residency is a community-based program in Kansas City, MO offering diverse patient base & strong inpatient experience in a tertiary care hospital & outstanding obstetrics experience with optional OB & Integrative Medicine Tracks. Opportunities for Medical Mission rotations exist. Clinic is NCCO Level 3 Patient Centered Medical Home. Our program is known for its nurturing environment and quality faculty. Visit www.researchresidency.com

Frontier STEM HOSA

Booth 126

FrontierHOSA.Weebly.com
Christopher Kramer
ckramer@frontierschools.org
(913) 710-8151



Frontier STEM HOSA: Future Health Professionals is a student organization that is dedicated to development of leadership and clinical skills. Students in this organization participate in leadership training, medical competition events and community service. We encourage you to stop by so we can demonstrate our competition and tell you how we can benefit each other.

Project Partner

Booth 127

projectpartner.org
Kristen Levitt
kristen@projectpartner.org
(913) 991-9001



We're on a mission to end the extreme poverty crisis in rural China. Providing access to water, education and medical care are the primary ways we fight poverty. There are over 400M people in China living on less than \$2/day - that's more people than the entire population of the United States! Together we can make a difference and create a brighter future for families in rural China.

INMED

Booth 128

www.inmed.us
Elizabeth Burgos
office@inmed.us
(816) 444-6400 ext. 1



The Institute for International Medicine (INMED) exists to equip healthcare professionals and students with the unique skills necessary to effectively serve the world's most forgotten people. We are a nonprofit educational organization that offers didactic instruction in the full range of global health topics via online, hybrid, and in-classroom courses, as well as through conferences. We also complement such instruction with supervised service-learning experiences for healthcare students and professionals at over 45 INMED Training Sites in 20 low-resource countries.

HEALTH FOR THE WORLD

May 6, 2018



Spend the day with us at TopGolf enjoying games and learning about global health. This relaxed and casual event is the perfect opportunity to have fun and find out how you can save lives.

Together we can take our shot at making Health for the World a reality!

All proceeds to benefit Medical Missions Foundation. Lunch and cocktails will be provided.

Purchase your tickets and get more information about joining a mission by visiting www.MedicalMissionsFoundation.org



Not sure which INMED offering you qualify for?

Visit inmed.us/prospective-learners to find out.

Discover opportunities for:

- Medical Students (Before Clinical Rotations)
- Medical Students (After Clinical Rotations)
- Resident Physician
- Attending Physician
- Nursing Student Undergrad
- Nursing Student Adv Practice
- Nurse
- Nurse Advanced Practice
- Pharmacy Students (Before Clinical Rotations)
- Pharmacy Students (After Clinical Rotations)
- Pharmacist
- Physician Assistant Students (Before Clinical Rotations)
- Physician Assistant Students (After Clinical Rotations)
- Physician Assistants
- Midwife
- Midwifery Student
- Public Health Student
- Public Health Specialist
- Undergraduate Student
- Healthcare Administrator Student
- Healthcare Administrator
- Physical/Occupational Therapy Student
- Physical/Occupational Therapist
- Dental Students (Before Clinical Rotations)
- Dental Students (After Clinical Rotations)
- Dentist
- Dietitian Student
- Dietitian
- Non-Healthcare Personnel
- Other Healthcare Personnel



YWAM Ships Kona is a Christian nonprofit organization that uses ships to bring medical care to some of the most remote and isolated people in the Pacific. Our vessels are currently in Papua New Guinea.



Volunteer

WITH YWAM SHIPS



LOOKING FOR
Medical Professionals

Would you partner with us aboard our vessels? We are looking for doctors, nurses, dentists, ophthalmologists, surgeons & more. Join us to make a difference in unreached places.



SAIL | STUDY | *serve*

FREE Medicines and Supplies for Your Medical Outreach Trip

Americares Medical Outreach supports U.S.-licensed medical professionals traveling internationally to deliver medical and surgical care. Americares provides teams with free medicines and medical supplies, as well as educational and training resources.

Come visit us at booth 115!
americares.org/medicaloutreach



americares
Medical Outreach

Visit conference participants presenting posters throughout the lobby and Exhibit Hall

THURSDAY POSTER PRESENTATION HOURS

- 8:00am – 9:00am
- 9:50am – 10:00am
- 10:50am – 11:00am
- 12:00pm – 1:30pm – Presentation to judges and attendees in Room 102
- 2:20pm – 2:40pm
- 3:40 – Poster presentation award winners announced

*There are people living
and dying without Jesus.*

Do you want to see this change? We do.



From its earliest years, SIM has cared for and about those who live and die without hearing God's good news, compelling us into communities where He is least known. Over a century later our heart remains the same, now with around 4,000 multiskilled workers from 65 countries. Serving together on six continents, we pursue hard places through prayer and care as we respond to need, proclaim the gospel, and equip the Church.

SIM Healthcare Ministries invites you to pray about joining us in God's healing work among those broken in spirit, soul, and body as we share the good news through community health outreach, clinics, hospitals, and beyond.

SIM

Opportunities to serve include
short term, midterm, and long term.
simusa.org/getstarted

Continuing Education

Physicians

Thursday, April 12, 2018

Institute for International Medicine is accredited by the Missouri State Medical Association to provide continuing medical education for physicians.

The Institute for International Medicine designates this enduring material for a maximum of *4.75 AMA PRA Category 1 Credit(s)*[™]. Physicians should claim only the credit commensurate with the extent of their participation in the activity.

Friday, April 13, 2018

Institute for International Medicine is accredited by the Missouri State Medical Association to provide continuing medical education for physicians.

The Institute for International Medicine designates this enduring material for a maximum of *7 AMA PRA Category 1 Credit(s)*[™]. Physicians should claim only the credit commensurate with the extent of their participation in the activity.

Desirable Physician Attributes:

ACGME/ABMS: Patient Care & Procedural Skills; Medical Knowledge

IOM: Provide Patient-Centered Care; Work in Interdisciplinary Teams; Employ Evidence-Based Practice

IEC: Value/Ethics for Interprofessional Practice; Roles/Responsibilities; Interprofessional Communication; Teams and Teamwork

Nursing

Thursday, April 12, 2018

Institute for International Medicine is an approved provider of continuing nursing education by the Midwest Multistate Division, an accredited approver by the American Nurses Credentialing Center's Commission on Accreditation.

MW MSD Provider Approval # MO620-2

Contact hours: 4.75

Friday, April 13, 2018

Institute for International Medicine is an approved provider of continuing nursing education by the Midwest Multistate Division, an accredited approver by the American Nurses Credentialing Center's Commission on Accreditation.

MW MSD Provider Approval # MO620-2

Contact hours: 7

Certificate of Completion

A certificate of completion is provided to all participants upon request via the activity evaluation form. It is the responsibility of the individual to submit their certificate of completion and supporting documentation (if applicable) to their required oversight board for credit.

Continuing Education

Planning Committee Disclosures:

Micah Flint, MPA, RN, DINPH	INMED	Nothing to Disclose
Nicholas Comninellis, MD, MPH, DIMPH	INMED	Nothing to Disclose
Elizabeth Burgos, MPA	INMED	Nothing to Disclose
Nathaniel Uhl, BSN	KU Med	Nothing to Disclose
Jay Grimwood	Graceway	Nothing to Disclose
James Fyffe, BSN	INMED	Nothing to Disclose
Donald Philgreen, MD	Research Family Medicine Residency	Nothing to Disclose

No commercial support received. No relevant financial relationships with ACCME – defined commercial interests for anyone who was in control of the content of this activity.

There is no conflict of interest for anyone with the ability to control the content of this activity.

Successful completion of this activity requires:

- Check-in both days.
- Attendance to the presentations you self-selected (not all presentations offer CE). Partial credit is available.
- Participation through discussion, questions, and hands-on activities.
- Completion of conference evaluation and credit claims form.
- Evidence of completed online course prerequisite (if applicable).
- Completed check-off (if applicable).

Objectives:

Not all presentations are accredited for continuing education. Please see the agenda for those presentations marked as not being accredited.

At the completion of this activity, I am able to:

- Discuss the art of serving those in need holistically.
- Analyze medicine as an art and not strictly science.
- Review evidence-based pediatric care in limited resource setting.
- Articulate the prevention, diagnosis, and management of common diseases of poverty.
- List priorities of triage in low resource settings.
- Articulate the diversity of careers in global health.
- Relate culture with health.
- Evaluate the role of development programs to mitigate human trafficking.
- Explain humanitarian relief strategies and challenges.
- Discuss the correlation between culture and faith.
- List steps to assessing and managing wound care with limited resources.
- Analyze the goals and outcomes of response vs. development strategies.
- Review best-practices in providing trauma induced mental health services.
- Assess the medical needs of refugees.
- Develop tools to mitigate compassion fatigue.
- Evaluate community assessment strategies and plans.
- Express the role of spiritual health assessments integrated into a history and physical.

2018 Awards

Fred Loper, MD, Comminellis Award for Compassionate Service To Humanity Award Recipient

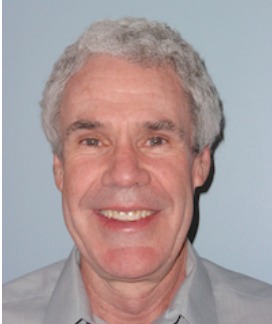

As a medical student at the University of Oklahoma, Fred Loper was recruited to help start Good Shepherd Clinic in Oklahoma City – a ministry launched after a homeless man had his wound stitched by a bartender in a local tavern because he had nowhere else to go for treatment. Following graduation, Dr. Loper proceeded to lead the Baptist Medical Dental Fellowship for twelve years, facilitating healthcare in Guatemala, Dominican Republic, Ghana, and Cuba. 2012 through 2016, Dr. Loper was again at the helm of Good Shepherd Clinic, providing medical and dental care to low-income and uninsured people throughout central Oklahoma. In this context he also mentored students from University of Oklahoma Health Sciences Center, who enjoyed the inspiring privilege of witnessing Dr. Loper's excellence in action.

Mary Smith, RN Cross-Cultural Healthcare Leadership Award Recipient



In 1988 Mary, a master's degree trained registered nurse, travelled with her Methodist church to Haiti. Motivated through this event, Mary herself lead multiple teams back to Haiti over the coming years. In 1999, while teaching nursing at Johnson Country Community College she began taking nursing students to Mexico where they provided care to those living in a squatter's community. That annual college trip continues even today. In 2009, Mary Smith made an exploration trip to Uganda. Thus, began annual visits to that nation as well, where for Ugandan nursing students and faculty she continues teaching Helping Babies Breathe – a skill set she acquired through INMED in 2010. Mary advises, "First just go to walk along side. As you do so, observe, learn, trust, respect, and let them teach you, too."

2018 Awards

James, RN, International Healthcare Healthcare Preceptor Award Recipient

James, a Kansas City native, began his career as a youth pastor in El Salvador. James later qualified as a registered nurse, serving at Saint Luke's Hospital and North Kansas City Hospital. At the 2012 Humanitarian Health Conference James met representatives from a healthcare organization working in a remote location in Asia. In 2015, James and his wife Rosie moved to that nation with their two pre-school children. James main responsibility in Asia continues to be instructing and mentoring national nursing students to give quality care to their own people. James, who was a volunteer at the very first INMED Humanitarian Health Conference in 2006, is also today an INMED International Medicine Fellow.

Betsy Sutherland National Healthcare Service Award Recipient



As an elementary school teacher, Betsy became absorbed over the tragedies surrounding human trafficking, including labor, sex and child trafficking. She carried these convictions into medical school at Saint Louis University, where her experience in education was quickly recognized by her peers within the anti-trafficking community. Betsy is connected with the Stop Human Trafficking Network where she leads small group, hands-on trafficking case simulations to help learners to rapidly recognize and respond to abusive situations. Watch for more advocacy and innovation from Betsy Sutherland in the next season of her life as a family physician in South Bend, Indiana.

Graceway Main Floor

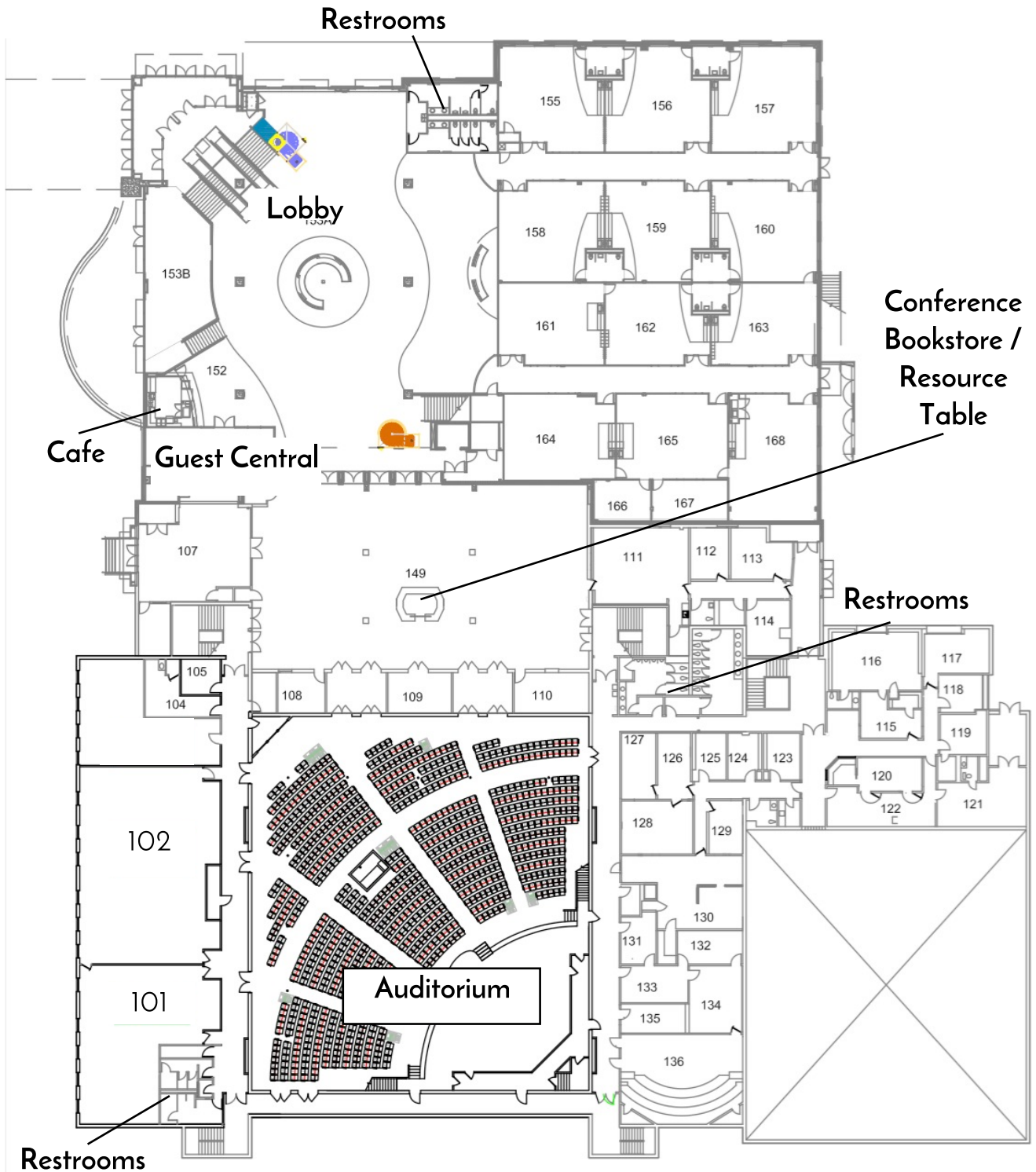

Graceway 2nd Floor

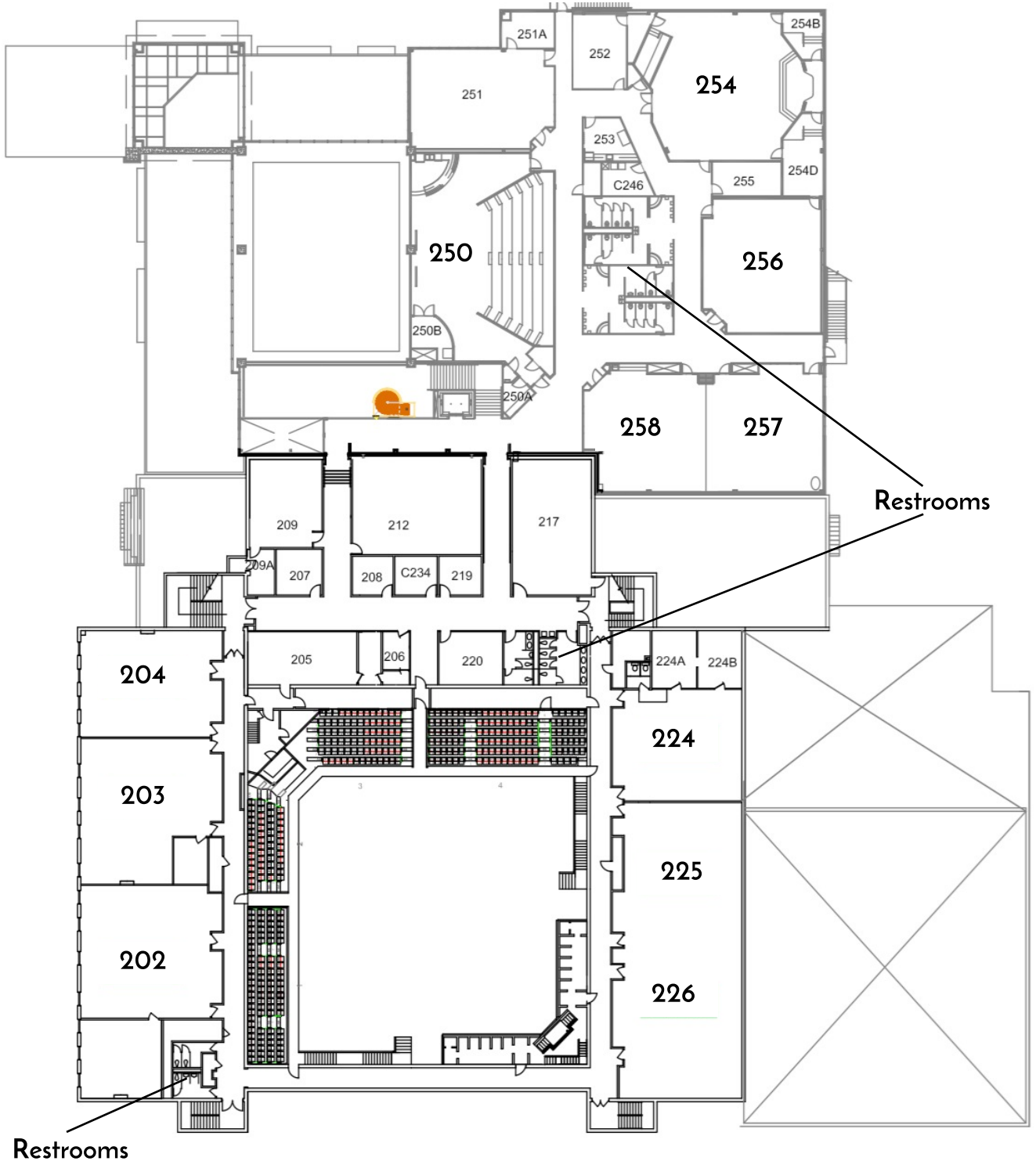

Thursday, April 12, 2018 - Conference Day 1

8:00 – 9:00 am – Check in/Registration, **Lobby**

9:00 – 9:10 am – Opening, **Auditorium**

9:10 – 9:50 am – Plenary Session 1, Fred Loper, MD, **Auditorium**

10:00 – 10:50 am – Breakout 1

Pediatric Care in the Limited Resource Setting, Katie Richardson, MD, **Room 102**
Diseases of Poverty, Nicholas Comninellis, MD, MPH, DIMPH, **Room 203**
Triage in a Low Resource Setting, Rick Randolph, MD, **Room 225**
Careers in Global Health, James, RN, **Room 250**
Cultural Influences of Health, Joe LeMaster, MD, **Room 224**
Development Programs to Stop Human Trafficking, Betsy Sutherland, **Room 202**
Humanitarian Relief, Micah Flint, MPA, RN, DINPH, **Room 204**
*Culture and Faith**, Jay Grimwood, **Room 101**

11:00 – 11:50 am – Breakout 2

Pediatric Care in the Limited Resource Setting, Katie Richardson, MD, **Room 102**
Wound Care, Glen Talboy, MD, **Room 225**
Diseases of Poverty, Nicholas Comninellis, MD, MPH, DIMPH, **Room 203**
Cultural Influences of Health, Joe LeMaster, MD, **Room 224**
Careers in Global Health, James, RN, **Room 250**
Response vs Development, Hayley Stolzle, MPH, **Room 202**
Humanitarian Relief, Micah Flint, MPA, RN, DINPH, **Room 204**
*Spiritual Health on the Field**, Judith LeMaster, RN, **Room 101**

12:00 pm – Lunch/Poster Presentations/Visit Exhibitors, **Lobby**

1:00 pm – Student Scholarship Photo, **Lobby**

1:30 – 2:20 pm – Breakout 3

Trauma Induced Mental Health, Lawand Abdulrahman, LLM, **Room 102**
Medical Needs of Refugees, Tim Myrick, MD, **Room 225**
Triage in a Low Resource Setting, Rick Randolph, MD, **Room 203**
Tools to Mitigate Compassion Fatigue, Fred Loper, MD, **Room 250**
Community Assessment and Planning, Jeff Palmer, **Room 258**
Response vs Development, Hayley Stolzle, MPH, **Room 204**
Spiritual Health Assessment, James, RN, **Room 202**
*Culture and Faith**, Jay Grimwood, **Room 101**

2:20 – 2:40 pm – Break/Visit Exhibitors/Posters, **Lobby**

Day 1 continued to next page...

2:40 – 3:30 pm – Breakout 4

Trauma Induced Mental Health, Lawand Abdulrahman, LLM, **Room 102**

Medical Needs of Refugees, Tim Myrick, MD, **Room 250**

Wound Care, Glen Talboy, MD, **Room 225**

Tools to Mitigate Compassion Fatigue, Fred Loper, MD, **Room 224**

Development Programs to Stop Human Trafficking, Betsy Sutherland, **Room 202**

Community Assessment and Planning, Jeff Palmer, **Room 258**

Spiritual Health Assessment, James, RN, **Room 202**

*Spiritual Health on the Field**, Judith LeMaster, RN, **Room 101**

3:30 – 3:40 pm – Announcements, **Auditorium**

3:40 – 4:20 pm – Plenary Session 2, Lori Clements, **Auditorium**

*Faith-Based Sessions, Not Accredited for Continuing Education Credit: *Spiritual Health on the Field* and *Culture and Faith*

Friday, April 13, 2018 - Conference Day 2

Please visit exhibitors during the breaks between sessions and at lunchtime.

Ultrasound for Primary Care, David Culpepper, **Room 203**

Helping Babies Breathe Course, Winston Manimtim, MD, **Room 101**

Humanitarian Relief Course, Micah Flint, MPA, RN, DINPH, **Room 225/226**

BLSO™ - Basic Life Support in Obstetrics, Donald Philgreen, MD, **Room 257/258**

Community Development Course, Jeff Palmer, **Room 202**

*Global Missions Course**, Jay Grimwood, Elisha Katamura, **Room 102**

8:00 am – 9:30 am – Session 1

9:40 am – 12:00 pm – Session 2

12:00 pm – 1:00 pm – Lunch, **Lobby**

1:00 pm – 2:00 pm – Session 3

2:00 pm – 2:10 pm – Break, **Lobby**

2:10 pm – 3:30 pm – Session 4

3:40 pm – 5:00 pm – Session 5

End of Conference

*Faith-Based Session, Not Accredited for Continuing Education Credit: *Global Missions Course*



Early Bird Registration for the 2019 Humanitarian Health Conference is Available at the Bookstore

*Equipping Healthcare Professionals
and Students to Serve the Forgotten*