

#2017HHC

---

# 2017 HUMANITARIAN HEALTH CONFERENCE

---

*"Holistic Partnership with the Forgotten"*

---



*Hosted by the Institute for International Medicine, Graceway and ACIHE*



# Welcome

**Calamity and opportunity.** This is the character of 2017. As we open the 12th annual INMED Conference, we are riveted by cataclysmic world events: the deadly conflict in the Middle East, unceasing war in Sudan, heightened tensions in North America and Eurasia, and predictably, the greatest forced migration of refuge seekers since World War II.

Amid this state of affairs you are joining us for the 2017 Humanitarian Health Conference, where our theme is *Holistic Partnership with the Forgotten*. Your presence at this event is testimony that amid calamity there also exists unprecedented opportunity to express compassion and to equip people with hope and skill to improve the quality of their lives. What undertaking could be more laudable?

At this event you will meet some of the most energetic, innovative and kind-hearted persons. Take advantage of each conversation to be as inspired and to create the relationships that will help you take part in turning calamity into opportunity for good.

*Nicholas Comninellis*

Nicholas Comninellis, MD, MPH, DIMPH  
President, Institute for International Medicine



*Nicholas Comninellis, MD*

## Table of Contents

Welcome .....	2
About INMED .....	3
Corporate Sponsors .....	4
Individual Sponsors .....	5
Speakers .....	6-13
Hosts .....	13
Bookstore Hours .....	14
Exhibitors .....	16-23
Continuing Ed. ....	26
Awards .....	27-28
Graceway Maps ...	29-30
Schedule .....	31-33

# INMED

*Equipping Healthcare Professionals and Students to Serve the Forgotten*

**The Institute for International Medicine (INMED)** exists to equip



INSTITUTE FOR  
INTERNATIONAL  
MEDICINE

healthcare professionals and students to serve the forgotten. We are a nonprofit educational organization that offers didactic instruction in international health, diseases of poverty, and community health development via online and in-classroom courses as well as conferences. We also offer supervised international service-learning experiences for healthcare students and professionals at over 45 training sites in 20 low-resource countries.

## Service Learning

### Diplomas

International Medicine & Public Health Diploma

International Public Health Diploma

### Alumni Opportunities

Alumni Service Program Fellowship



Check out [inmed.us](http://inmed.us) to browse our list of international training sites.

## Courses

### Hybrid Courses

International Medicine & Public Health Hybrid Course

International Public Health Hybrid Course

### Online Self-Paced Courses

International Public Health  
Diseases of Poverty  
International HIV Medicine  
Cross-Cultural Competency  
Disaster Management  
International Health Leadership  
Maternal-Newborn Health

**For more information, please visit [inmed.us](http://inmed.us) or contact us at:**

**INMED**  
2340 E. Meyer Blvd.  
Building 1 Suite # 338  
Kansas City, MO 64132

**E-mail:** [office@inmed.us](mailto:office@inmed.us)  
**Phone:** 816-444-6400  
**Fax:** 816-444-6400

# Corporate Sponsors

Butterfield Memorial Foundation



College Park Family Care Center



George Faile Foundation



Hodgdon Family Charitable Fund



Hospital Corporation of America  
(HCA) Midwest



Jack Hill Continuing Medical  
Education Foundation



Research Medical Center



Gallagher Charitable International  
Insurance Services



Educate, Enrich & Enable Fund



# Major Donors

Datcha Dorvil  
Peter & Kathryn Greenspan  
Ted & Kim Higgins  
Spencer & Beckie Kerley  
Mike Searcy  
Cindy & Paul Shumpert  
David Zamierowski

# Individual Sponsors

Kate Alberts	Bruce Banwart	Andy Bukaty
Troy Burns	Nancy Crigger	Datcha Dorvil
Mark Duff	Nancy Dye	Colette Fleming
Bill Gilbirds	Peter & Kathryn Greenspan	Reuel Gregory
Ted & Kim Higgins	Kevin Hubbard	Juhi Kangas
Spencer & Beckie Kerley	Ali Khezrian	Gary Kindell
Scott Kujath	Winston Manimtim	Allan Martin
Jose Martinez-Figueroa	Gary McEwen	David McKinsey
David Miller	Andy Moyes	Scott Murphy
Don & Martha Philgreen	Rick & Jo Randolph	Dean Reeves
Sequita Richardson	Jesse Roberts	Steve Salanski
Mike Searcy	Cindy Shumpert	Charles Sullivan
Glenn Talboy	Rory Tompkins	Bob Tung
Larry Van Vleet	Mitch Voelker	Jon Wada
Vince Waite	Audrey Williams	Julie Wood
Marty Kanne	Nancy Miller	Francine Stoner

# Speakers



*Nicholas Comninellis, MD,*

Dr. Comninellis is President of INMED and board certified in both public health and family medicine. Nicholas trained in tropical medicine at the Walter Reed Army Institute of Research, and served four years in Shanghai, China, and Angola, Africa. Today he teaches public health at the University of Missouri-Kansas City.



*Pam Franks, RN, BSN*

Pam's experience in international communities began with five years in Guatemala where she organized medical clinics into remote areas. After moving stateside, she worked extensively with international students for 15 years. Pam is founder of a Christian non-profit, Embrace the Nations, designed to meet holistic needs of local refugee communities.



*Lawand Abdulrahman*

A native of Kurdistan, northern Iraq's autonomous region, Lawand Abdulrahman serves with the UNHCR, providing care for Syrians seeking refuge in his country. Lawand is responsible for four refugee's camps, assisting these forcibly displaced people with food, shelter, medical care, and security conforming to international protection standards.

# Speakers



*Greg Seager, RN, MSN*

Greg Seager is the author of *When Healthcare Hurts: An Evidence Based Guide for Best Practices in Global Health Initiatives*. He holds a Masters in Nursing/ from The George Washington University. Greg is the Founder of the Christian Health Service Corps, an organization with full-time healthcare staff in 15 countries.



*Barry Bacon, MD*

Barry Bacon, MD provides full spectrum primary healthcare in a rural area of northeastern Washington. He teaches family medicine to U.S. residents and students, and annually, teaches in east Africa. Dr. Bacon and his wife work on the issues of homelessness, addiction, poverty and mental health in their Washington community and in Kapedo, Kenya.



*Vicki Hicks, MSN, RN, APRN-CNS*

Vicki Hicks is a Clinical Associate Professor and Advanced Practice Registered Nurse – Clinical Nurse Specialist in Community Health. She joined the faculty at the University of Kansas School of Nursing in 1992 and integrated global health experiences into practicum and population based clinical nursing courses for BSN and Master's students.

# Speakers



*Angie Schuber, RN, BSN*

Angie Schuber is the Chief Development Officer of Haitian Christian Mission. She graduated with her Bachelors of Science in Nursing with emphasis in Medical Missions in 2007. Angie's passion is to continue to pursue excellence in the areas of healthcare, education and spiritual growth for the people of Haiti.



*Charlie Inboriboon, MD, MPH*

Dr. Inboriboon is an Emergency Medicine Physician and Director of International Programs at Truman Medical Center and Children's Mercy Hospital. Dr. Inboriboon completed the University of Rochester International Medicine Fellowship. He has extensive international medicine experience and research. Dr. Inboriboon is an academic representative for the American Council for International Health Education.



*Richard Randolph, MD*

Dr. Randolph is a family physician from the Kansas City area who first distinguished himself as a West Point Military Academy graduate. In 2015, Dr. Randolph became Chief Medical Officer for Heart to Heart International. Today he diligently applies his hard-won insight through scaling up preparedness capability among hundreds of dedicated disaster responders.



# Speakers



*Brian Scheel*

Brian Scheel is the Director of Operations for Heart to Heart International (HHI). He oversees HHI's Product Distribution Program and has extensive international and field level emergency response experience – including Liberia during the 2014-2016 Ebola outbreak and the Philippines after Typhoon Haiyan.



*Roy Moran*

Roy Moran is the primary leader at Shoal Creek Community Church in Liberty, MO. Before founding Shoal Creek, Roy was the Vice President of Human Resources for the Fellowship of Christian Athletes. Roy is a graduate of Baylor University and Dallas Theological Seminary. He loves golf, his four children, and wife, Candy, in reverse order.



*Justin Carney*

Justin's ten years of experience in the Middle East has been focused on value chain creation and local and global collaboration among stakeholder groups. Mr. Carney has diverse experience in value chain creation and stakeholder engagement ranging from working alongside small share farmers in rural Kurdish villages to advising Governments.

# Speakers



*Laura Captari*

Laura Captari serves with Humanitarian Disaster Institute and is pursuing her doctorate in psychology at University of North Texas. Her research investigates the roles of attachment and spirituality in promoting resilience and post-traumatic growth. She is passionate about working with vulnerable populations, and has co-authored five books, including *Orphan Justice*.



*Regina Johnson, MSN, RN*

Regina (Gina) Johnson MSN, RN has been a nurse for over 25 years. She is the lead Population Health baccalaureate faculty for KU School of Nursing. Global Health is part of the Population Health curriculum and includes a clinical rotation where Ms. Johnson leads a clinical team in Guatemala.



*Gerald Roussie, Ph.D*

Dr. Roussie, a retired university professor, has led or participated in the leadership of more than 25 medical mission trips. One of his specialties is offering free eye examinations to more than 10,000 people around the world through Health Teams International, a Christian medical missions organization.

# Speakers



*Timothy Myrick, MD*

Timothy Myrick, MD is a family physician. He and his family have lived among and served Muslim populations since 1992. They have cared for settled groups, immigrants, and refugees in East Africa, North Africa, the Middle East, and the U.S.



*Scott Kujath, MD*

Scott W. Kujath, MD is a vascular surgeon at Midwest Vascular Surgery. Dr. Kujath serves as a volunteer and member of the Board of Directors of the Living Room Ministries International, a palliative organization in Kenya. Dr. Kujath was a key founder and Board Member of the Mission of Hope Clinic, a safety-net clinic in the Greater Kansas City Area.



*Paul Larson, MD*

Paul Larson, MD is Director of Global Health Education at the UPMC St. Margaret Family Medicine Residency. Following training in Family Medicine and Tropical Medicine, he practiced for two years in Kapsowar, Kenya. Returning to the USA, he completed a MS in medical education, a fellowship in faculty development and teaches INMED students in Ghana or Kenya every year.

# Speakers



*Calvin Wilson*

Dr. Wilson is Director of the University of Colorado Center for Global Health, where he collaborates with primary health care and health systems development in Ghana, Peru, and Indonesia. He also leads USAID and CDC collaborative projects to train family physicians in Rwanda and Albania. Dr. Wilson is the 2005 AAFP Humanitarian of the Year Award Recipient.



*Laura Smelter, MD*

Laura Smelter is the Director of Training for Christian Health Service Corps. A family doctor, she has worked in national and international clinical, academic, and administrative roles, including a term in Nigeria and a term in Haiti. She now helps prepare healthcare professionals to serve in relief and development.



*Jason Axt, MD, MPH*

Jason Axt is a Board Certified General Surgeon currently in Pediatric Surgery Fellowship at Children's Mercy Hospital in Kansas City. He served as faculty, teaching general surgery in Cameroon, West Africa from 2014 - 2016. He intends to return long-term after fellowship.

# Speakers



*Thad May, MS, PE*

Thad May, MS, PE, is a professional engineer with a specialty in water and sanitation. His work experience includes development projects in Zambia, Africa, and in China. Thad earned his B.S. in Civil Engineering and M.S. in Environmental Engineering from the University of Kansas. Thad previously served on the INMED Board of Directors.

# Hosts

---



INSTITUTE FOR  
INTERNATIONAL  
MEDICINE



# FREE Medicines and Supplies for Your Medical Outreach Trip

Americares Medical Outreach supports U.S.-licensed medical professionals traveling internationally to deliver medical and surgical care. Americares provides teams with free medicines and medical supplies, as well as educational and training resources.

Click here to request products and view resources:  
[americares.org/medicaloutreach](http://americares.org/medicaloutreach)



**americares**  
Medical Outreach

<http://americares.org/medicaloutreach>

## Conference Bookstore Hours

Friday, 9:00 am - 5:00 PM  
Saturday, 10:45 am - 12:45 PM

*Conference Bookstore is located on Main  
Floor at the Resource Table*

# Early Bird Registration Available

*Friday and Saturday Only*

Register for the 2018 HHC

Only \$100

Purchase 2018 Registration at the  
Conference Bookstore  
*No Refunds Available*

---

## Thank You!

### **A Special Thank You to the Following...**

Graceway Staff Team: Jay Grimwood, Dan Bly,  
Jeremy Schell, Jesse Hamilton, and Jeff Adams

Silber Spoons Catering

Simulation Makeup Artist: Shelli Clevenger and Quinn Clevenger

Conference Volunteers

Gallagher Charitable International Insurance  
Services for Sponsoring a Coffee Break

Conference sponsors and student scholarship donors

# Exhibitors

## *Heart To Heart International*

**Booth 101**

<http://www.hearttoheart.org/about/>  
Jillian O'Connell  
jillian.oconnell@hearttoheart.org  
(913) 764-5200



Heart to Heart International strengthens communities through improving health access, providing humanitarian development and administering crisis relief worldwide. We engage volunteers, collaborate with partners and deploy resources to achieve this mission.

## *A Cup of Water International*

**Booth 102**

[www.givetodrink.org/](http://www.givetodrink.org/)  
Daniel Kwon  
biblicalhot@gmail.com  
(267) 242-1798

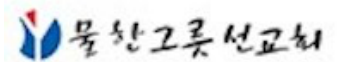

The first purpose of our ministry is to reach and reduce the number of unreached people groups with the gospel by using the provision of clean water to open their minds and hearts. We ask for your prayers for this ministry as we are blessed to use the gifts and training God has given us.

## *Medical Missions Foundation*

**Booth 103**

<https://www.medicalmissionsfoundation.org>  
Caroline O'Dell  
caroline@medicalmissionsfoundation.org  
(913) 338-0343



Our mission is to provide surgical and medical care in underserved communities throughout the world and to positively impact the lives of children and their families.



# Exhibitors

## *Hope Family Care Center*

hopecenterkc.org/programs/hope-family-care-center/  
Tom Kettler  
operationsdirector@hfckc.org  
(816) 618-6500

**Booth 104**



Hope Family Care Center (HFCC) is a faith-based family medical practice providing quality primary healthcare in Kansas City, Missouri's east side. All patients are welcome including the uninsured, those with insurance, Medicaid, or Medicare.

## *Franciscan Mission Warehouse*

www.franciscanmissionwarehouse.org  
Michael Straughn  
mstraughn@fmwarehouse.org  
(816) 812-7621

**Booth 105**



FMH gathers unused medical supplies and equipment that would otherwise go to waste. We store the equipment until we find a community needing an entire shipment of supplies, then we fill a shipping container with supplies and equipment and ship it to the community – anywhere in the world.

## *Christian Health Service Corps*

www.healthservicecorps.org  
Greg Seager  
info@healthservicecorps.org  
(903) 962-4000

**Booth 106**



Christian Health Service Corps is a ministry of Christian doctors, health professionals and health educators serving the poor in places that have little or no access to healthcare. Our doctors and health professionals serve long-term, providing compassionate, Christ-centered care with a focus on patient safety and best practices.

# Exhibitors

## *Interserve USA*

www.interserveusa.org  
John Kennedy  
jkennedy@ludlow.net  
(800) 809-4440

**Booth 107**



We are a community of ordinary people following Jesus Christ into the Asian and Arab worlds. Motivated by Christ's compassion and justice we use our skills to change tomorrow by what we do today....

## *International Health Partners, U.S., Inc, JEMA-TZ* **Booth 108**

www.ihptz.org  
Paula Lofstrom  
paula@ihptz.org  
(870) 404-4491



There are 22 million children in Tanzania under the age of 15 and no pediatric hospital to serve them. International Health Partners-JEMA-TZ opened the outpatient clinic in April, 2016. We are building The Mary Ellen Kitundu Memorial Birthing Center and Neonatal ICU. Teams do medicine, assist with construction, and help organize and inventory donated items by the container-load. Welcome!

## *Fly For Good*

www.flyforgood.com  
Anthony Hilden  
anthony@flyforgood.com  
(952) 886-7676

**Booth 109**



Fly For Good provides discounted international airfare for churches and nonprofits. We own our own direct contracts with over 35 airlines. Email anthony@flyforgood.com for a quote on your next trip. Our prices and service will amaze you and help save your organization time and money.



# Exhibitors

## *Mission Nation Travel*

**Booth 110**

www.missionnation.com  
Deborah Franco  
deborah401@outlook.com  
954-947-2306



Mission Nation is dedicated to providing comprehensive solutions that help overcome the complexities of international travel planning. Our travel experts have unique access to benefits that can save you a lot of money and provide a better experience. We navigate through numerous travel options allowing you to make an informed decision that will meet your needs and provides sound stewardship.

## *World Outreach Foundation Kansas City*

**Booth 111**

www.worldoutreachfoundation.org  
Jerry Smith  
jerry@worldoutreachfoundation.com  
(816) 560-9379



World Outreach Foundation Kansas City is committed to making a sustainable, long term and life changing difference in the lives of those without regular access to medical care through innovative provision of healthcare services. Our primary programs are the provision of overseas medical, dental and surgical missions, and dental and medical clinics for the Homeless in Kansas City.

## *International Service Learning*

**Booth 112**

www.islonline.org  
Sagen Eatwell  
sagen@islonline.org  
(877) 779-8075



International Service Learning (ISL) is an organization that has been offering volunteers practical experience through medical, education, and community enrichment programs while offering sustainable aid in developing communities for over 20 years. ISL teams are open to volunteers who are interested in gaining valuable experience, exploring another culture, and assisting those in need.

# Exhibitors

## *Living Room Ministries International*

**Booth 113**

<http://www.livingroominternational.org>  
Dennis McGowan  
[dennismcgowan@sbcglobal.net](mailto:dennismcgowan@sbcglobal.net)  
(530) 246-0693



Living Room International is a ministry to those with life threatening diseases in Kenya Africa. We provide free palliative care to the poor and marginalized. We provide in-patient & out-patient care, physical therapy and care to at risk children. We have a 24 bed hospice on our first campus and are currently building a second campus with a 52 bed hospice, education center and mortuary services.

## *Docs Who Care*

**Booth 114**

[www.docswhocare.com](http://www.docswhocare.com)  
Michael Seward  
[mseward@docswhocare.com](mailto:mseward@docswhocare.com)  
(913) 397-7800



Docs Who Care provides physician and mid-level staffing throughout the Midwest (states of MO, KS, IA, NE, CO). Consider joining our team serving rural communities a limited number of days per month, allowing time and flexibility to pursue family, volunteerism, and outside interests. Visit [www.DocsWhoCare.com](http://www.DocsWhoCare.com). Dr. Gary Morsch is the founder of Docs Who Care and Heart to Heart International.

## *George Faile Foundation*

**Booth 115**

[www.failefoundation.org](http://www.failefoundation.org)  
Paul Shumpert  
[info@failefoundation.org](mailto:info@failefoundation.org)  
(706 ) 291-4036



The George Faile Foundation supports Baptist Medical Centre in Northern Ghana. We offer scholarships to medical students and residents that volunteer at BMC, an INMED training site. We provide a variety of other support services for the hospital.

# Exhibitors

## *YWAM Ships, Kona, HI*

ywamships.net  
Kimberly Ward  
medicalvolunteers@ywamships.net  
(808) 757-9150

Booth 116



YWAM Ships Kona exists to reach the isolated & disadvantaged islands. Using ships to access these villages is not just the best option... it is the only one. Hop aboard the m/v PACIFIC LINK & bring hope to the isolated islands. We rely on a global volunteer base to provide education & health care in places with great need. Medical volunteers of all skill levels are encouraged to serve with us

## *All God's Children*

allgodschildrenkc.com  
Vicki Cooper  
vickidhc@aol.com  
(816) 429-7475

Booth 117



All God's Children is a Christian compassion organization that seeks ways to help the lost, sick, oppressed, poor and vulnerable children in practical ways. Currently Murundu Mission Hospital of Hope is being completed in Zambia. Samaritan's Purse has partnered with us to complete this project. We will need teams to go to provide expert care while partnering with medical professionals in Zambia.

## *Dignity:Liberia*

dignityliberia.org  
Kathi Gutierrez  
kathi@dignityliberia.org  
(816) 217-8751

Booth 118



Dignity:Liberia is committed to bringing restoration and hope to women with fistula, and their communities, through healing, education, and prevention.

# Exhibitors

## *INMED*

www.inmed.us  
Elizabeth Burgos  
office@inmed.us  
(816)444-6400



*Booth 119*

INSTITUTE FOR  
INTERNATIONAL  
MEDICINE

The Institute for International Medicine (INMED) exists to equip healthcare professionals and students with the unique skills necessary to effectively serve the world's most forgotten people. We are a nonprofit educational organization that offers didactic instruction in the full range of global health topics via online, hybrid, and in-classroom courses, as well as through conferences. We also complement such instruction with supervised service-learning experiences for healthcare students and professionals at over 45 INMED Training Sites in 20 low-resource countries.

## *Haitian Christian Mission*

www.haitianchristianmission.org  
Angie Schuber  
angie@haitianchristianmission.org  
(844) 426-1974

*Booth 120*



Showing Haiti Christ's love through education, medical care, nutrition, employment, evangelism, and child sponsorship since 1974. Our mission is to feed the body, mind, and spirit of the Haitian people.

## *Mission of Hope Clinic*

www.missionofhopeclinic.com  
Michelle Williams  
michelleformoh@gmail.com  
(816) 356-4325

*Booth 121*



The Mission of Hope Clinic provides a faith-based healthcare home for the uninsured and underserved in the Kansas City Metro area. Services include Medical and Dental care, as well as Titters for those working, or applying to work, in the medical/ medical missions field. The Mission of Hope Clinic provides an excellent resource for those seeking mission opportunities within the United States.

# Exhibitors

---

## *All India Mission*

[www.allindiamission.com](http://www.allindiamission.com)  
Hope Howe  
[hope@allindiamission.com](mailto:hope@allindiamission.com)  
(913) 829-6555

*Booth 122*



All India Mission is displaying Shanti Bhavan Medical Center. The state of the art hospital opened in early 2014 and the staff is treating an average of 2,500 patients per month. New services now offered include a fully operating cardiology department and ophthalmology unit. Our Rural Medical Services and Community Health Leaders are also reaching thousands of the poor and needy in north India

---

## *Emmanuel Hospital Association - USA*

<http://www.ehausa.org>  
Howard Searle  
[hsearle@ehausa.org](mailto:hsearle@ehausa.org)  
(630)802-5364

*Booth 123*



EHA-USA exists to encourage and facilitate prayer and financial support for Emmanuel Hospital Association, an indigenous [41 years] health care ministry to the poor and marginalized in North and NE India through their 20 hospitals and 42 community health and development projects, plus thematic ministries such as Disaster Relief, Palliative Care, and mainstreaming care for handicapped people.

# Did You Know?

INMED offers training courses in

*Helping Babies Breathe*

and

*Ultrasound for Primary Care*

throughout the year...

Sign up online for an upcoming course at

[www.inmed.us](http://www.inmed.us)

## Not sure which INMED offering you qualify for?

Visit [inmed.us/prospective-learners](http://inmed.us/prospective-learners) to find out.

### Discover opportunities for:

- Medical Students (Before Clinical Rotations)
- Medical Students (After Clinical Rotations)
- Resident Physician
- Attending Physician
- Nursing Student Undergrad
- Nursing Student Adv Practice
- Nurse
- Nurse Advanced Practice
- Pharmacy Students (Before Clinical Rotations)
- Pharmacy Students (After Clinical Rotations)
- Pharmacist
- Physician Assistant Students (Before Clinical Rotations)
- Physician Assistant Students (After Clinical Rotations)
- Physician Assistants
- Midwife
- Midwifery Student
- Public Health Student
- Public Health Specialist
- Undergraduate Student
- Healthcare Administrator Student
- Healthcare Administrator
- Physical/Occupational Therapy Student
- Physical/Occupational Therapist
- Dental Students (Before Clinical Rotations)
- Dental Students (After Clinical Rotations)
- Dentist
- Dietitian Student
- Dietitian
- Non-Healthcare Personnel
- Other Healthcare Personnel





# Bookstore

## *Bookstore Hours*

Friday, 9:00 am - 5:00 PM  
Saturday, 10:45 am - 12:45 PM

*Conference Bookstore is located on Main Floor.*

## Best Sellers

### **Disaster Response Handbook**

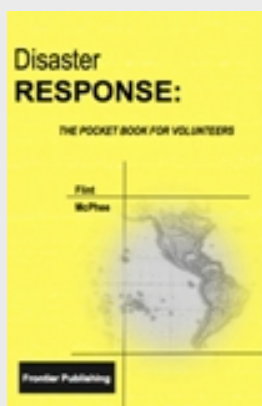

*Available at the  
Conference Bookstore*

### **INMED Book, 2nd Edition**



*Available at the  
Conference Bookstore*

**OBJECTIVES**

At the completion of this conference, I am able to:

- Articulate the Sphere standards for humanitarian relief efforts.
- Review disease mitigation strategies in limited resource settings.
- Demonstrate proper use of ultrasound in primary care.
- Demonstrate triaging patients in a mass casualty simulation.
- Review diagnosis and treatment strategies of critically ill pediatric patients in a limited resource setting.
- Articulate key strategies in reducing maternal/child vulnerabilities in resource poor communities.
- Discuss strategies to improve community health in a low resource community.
- Review W.A.S.H. standards
- Discuss the correlation of literacy with health.
- Articulate the unique challenges in providing holistic health services to refugee and displaced people groups.
- Describe techniques to cross-cultural boundaries.
- Develop steps to engage into humanitarian health work.
- Demonstrate the strategies and effective response to a humanitarian crisis situation.

**Physicians**

Institute for International Medicine is accredited by the Missouri State Medical Association to provide continuing medical education for physicians.

The Institute for International Medicine designates this live activity for a maximum of 9.25 *AMA PRA Category 1 Credit(s)*<sup>™</sup>. Physicians should claim only the credit commensurate with the extent of their participation in the activity.

**Desirable Physician Attributes/Core Competencies****ACGME/ABMS**

- Patient Care & Procedural Skills
- Medical Knowledge

**IOM**

- Work in Interdisciplinary Teams
- Employ Evidence-Based Practice

**IEC**

- Value/Ethics for Interprofessional Practice
- Roles/Responsibilities
- Interprofessional Communication
- Teams and Teamwork

**Nurses**

Institute for International Medicine is an approved provider of continuing nursing education by the Mid-West Multistate Division, an accredited approver by the American Nurses Credentialing Center's Commission on Accreditation.

Approval to present this program does not imply ANCC or MSD approval or endorsement of any commercial products. The participant will receive 9.25 contact hours. Instructions for obtaining certificates will be distributed at the conclusion of the program.

Provider # 717-V  
Contact hours: 9.25

Planning Committee Disclosures:

Micah Flint MPA RN DIPH	Nothing to Disclose	INMED
Nancy Crigger PhD MS ARNP	Nothing to Disclose	INMED
Nicholas Comninellis MD DIMPH	Nothing to Disclose	INMED
Elizabeth Burgos MPA	Nothing to Disclose	INMED

**Don't see your profession?** INMED can provide a Certificate of Completion to conference attendees with the *AMA PRA Category 1 Credit(s)*<sup>™</sup> statement. Complete the conference evaluation and request your Certificate.

# 2017 Awards

## *Lawand Talal, Comninellis Award*

### *for Compassionate Service To Humanity Award Recipient*



Compassion is at the center of Lawand Talal's professional life. This American-trained Kurdish attorney abandoned a lucrative career to instead join the United Nations High Commissioner for Refugees of behalf of Syrians searching for asylum in Iraqi Kurdistan. Refugees include the entire spectrum of humanity. Disabled Syrian refugees are Lawand's specialty, bringing to bear the principles of international law on behalf of those afflicted by cerebral palsy, learning disorders, schizophrenia, paraplegia; in short, people who are the *least capable* of defending themselves. "We Kurds are a persecuted people, condemned for centuries by foreign lords," proclaims Lawand Talal. "So, when Syrians fleeing utter terror from ISIS arrive at our borders how can we not but respond with compassion?"

## *Juli McGowan Boit, MSN, RN*

### *National Healthcare Service Award Recipient*



Juli McGowan Boit lives a life of international compassion. This began with a month-long trip to Kenya in 2000 with her nursing school; one that filled her with a calling to serve the people in East Africa. "My eyes were opened to poverty in a new way, and not just the hard things about Africa, but also really beautiful things," says Juli. In 2004, she moved to Kenya to work as a nurse practitioner, and in 2009 she founded Living Room Ministries - a place that offers dignity and whole person - physical, emotional, spiritual - care to those battling life-threatening illnesses like HIV/AIDS, and an alternative for the sick or dying who are ostracized by their communities and families.

## *Pam Franks, RN, Cross-Cultural*

### *Health Service Award Recipient*



Pam Franks, RN BSN, began serious cross-cultural endeavors when she and her husband moved to Guatemala. During their five-year residency, she helped lead the medical care of a large Christian organization, which included clinics in remote parts of the country. Back home in Omaha, Pam launched Embrace the Nations in 2009, an organization focused on assisting refugees from Somalia, Sudan, Burundi, Bhutan and Burma. Pam and her team provide English language learning, life skills like vehicle maintenance and parenting, and assisting their children with tutoring and school success. Pam's insight and vision is broadly respected, and she's consistently called upon to lead cross-cultural skills training for nursing and medical students, churches and businesses, service organizations, and law enforcement officers.

# 2017 Awards

*Vicki Hicks, RN, International*

## *Healthcare Preceptor Award Recipient*



Vicki Hicks, RN MSN, entered international service via trips through Village Presbyterian Church and Mercy & Truth Medical Missions. Vicki, who has been teaching nursing at Kansas University Medical Center, next became inspired to create similar opportunities for her students, and for some twenty-five years KU nursing students have enjoyed these formative experiences. Just months ago, she facilitated twenty-three students to experience healthcare in Guatemala, Gulu -Uganda, CMC Vellore - India, palliative care in Belgium, and refugee health here in Kansas City through Jewish Vocational Services and Catholic Charities. Throughout, Vicki emphasizes a population-based approach to understanding health needs, as well as a *sustainable partnership* approach to meeting these needs.

*Haitian Christian Mission, Humanitarian*

## *Crisis Response Award Recipient*



On the morning of October 4, 2016, Hurricane *Matthew* slammed into Haiti with winds of 145 miles per hour - the first Category 4 storm to strike Haiti since 1964. Haitian Christian Mission's *Hopital Christ Pour Tous* opened in 1981, was already in preparation mode. Immediately following the storm, Edwens Prophete, HCM CEO, and Angie Schuber, RN, BSN, Chief Development Officer, made a rapid assessment of emergency needs. Clean water sources were flooded, and so a new well was dug and medical services for anticipated cholera treatment were implemented. Meanwhile, HCM's ongoing CDC-recognized HIV care clinics, and HCM's peanut butter nutritional assistance were continued. Through it all, medical director Dr. Deiunord prayed with his patients and reminded the entire Haitian staff, "Why we do what we do."

*Greg Seager, MSN, RN,*

## *Cross-Cultural Leadership Award Recipient*



Greg Seager, RN MSN, and his wife, Candi, first became involved in cross-cultural healthcare when invited by their home church. Moving up quickly in leadership, they were soon overseeing six to eight medical teams to Haiti each year. Later they became full-time staff with Mercy Ships, where part of Greg's role involved Implementing Integrated Management of Childhood Illness (IMCI) protocols, and program evaluation. Greg's critique of international healthcare is best embodied in his book, *When Healthcare Hurts: An Evidence Based Guide for Best Practices in Global Health Initiatives*. In 2010, Greg and Candi launched a new healthcare sending organization to embody these innovations. Christian Health Service Corps today empowers fifty full-time personnel serving in fifteen developing nations.

# Graceway Main Floor

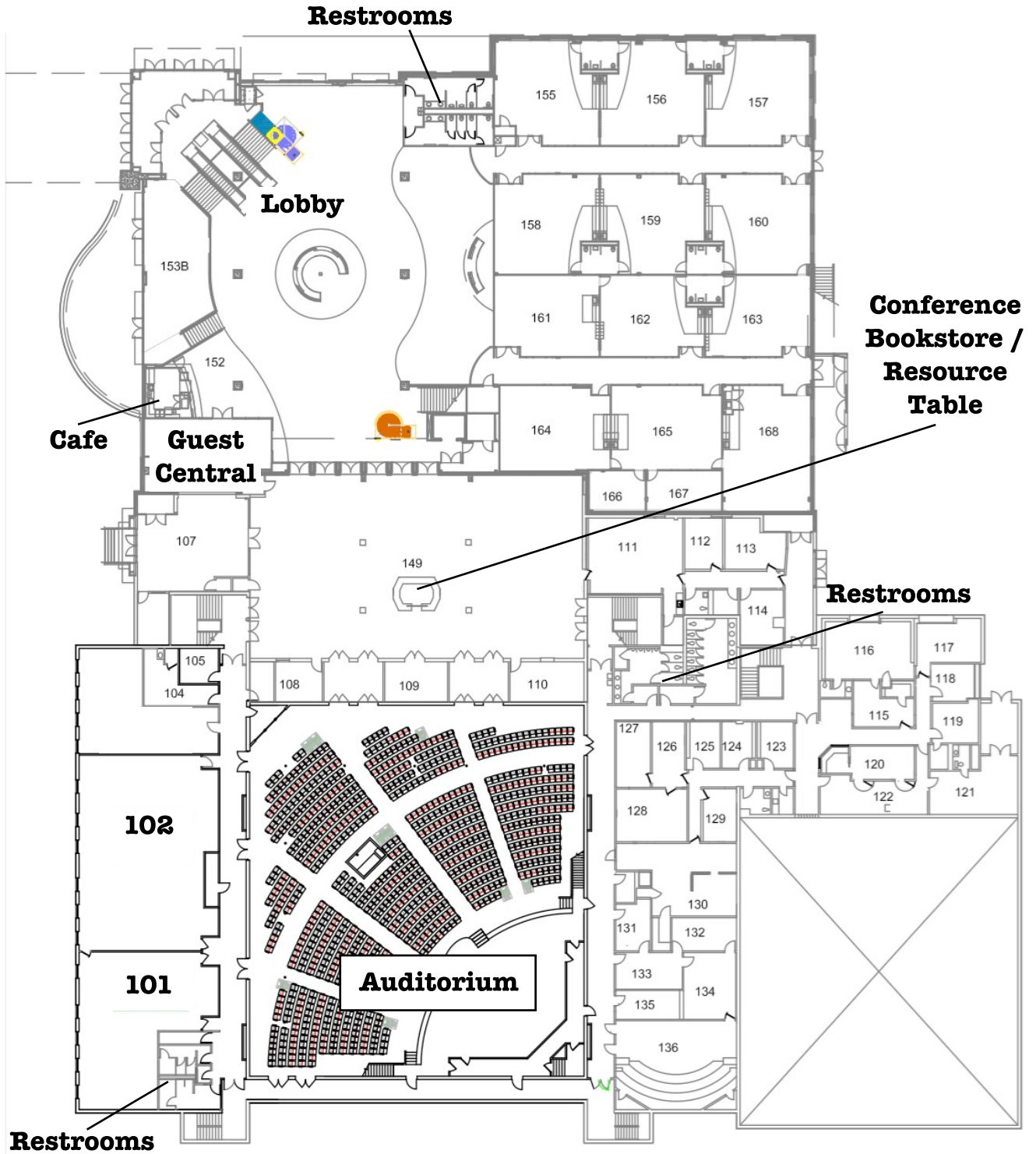

# Graceway 2nd Floor

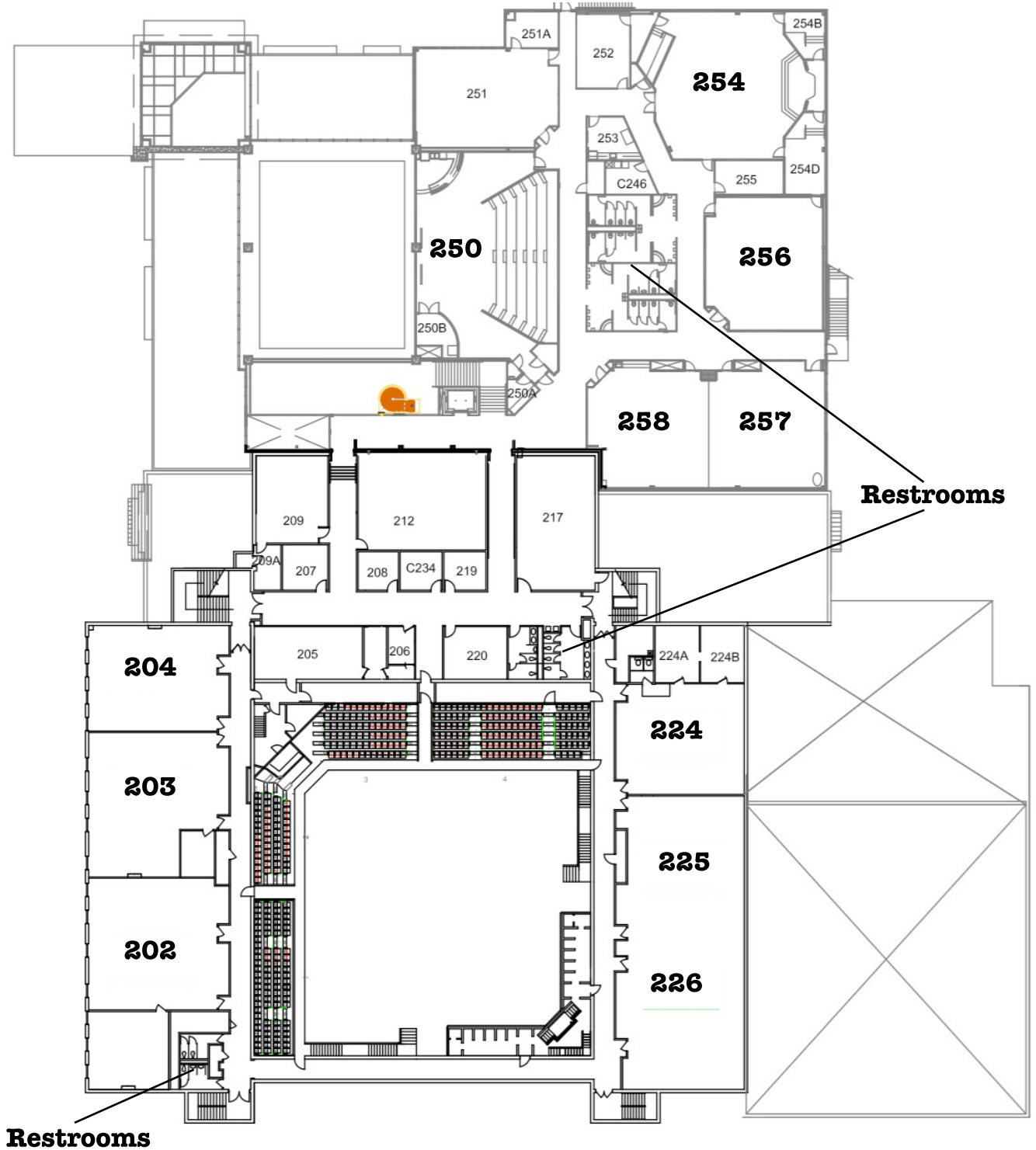

# Friday Conference Schedule

\* Faith-based  
\*\* CE accredited

# 2017 Humanitarian Health Conference

8:00 - 9:00 AM	Registration and Visit Exhibitors		Lobby/Exhibit Hall
9:00 - 9:45 AM	<b>Plenary 1</b> - <i>The Forgotten of this World</i> - Lawand Abdulrahman		Auditorium
9:50 - 10:40 AM	<b>Breakout Session 1</b>		
	<b>Topic</b>	<b>Track</b>	<b>Room</b>
	W.A.S.H.**	W.A.S.H. (Water, Sanitation, Hygiene)	Rm. 202
	<i>Embrace the Nations: An Example of Holistic Partnerships in the Refugee Community**</i>	Serving the Forgotten	Rm. 102
	<i>Creating a Medical Chart &amp; Taking a Blood Pressure</i>	Non-Clinicians in the Clinical Setting	Rm. 203
	<i>Preparing to Go: What You Need to Know Before You Go</i>	Personal Development	Rm. 258
	<i>Critically Ill Pediatric Patient in Limited Resource Setting**</i>	Clinical Track	Rm. 225/226
	<i>Developing Hygiene Programs and Products **</i>	W.A.S.H. (Water, Sanitation, Hygiene)	Rm. 224
	<i>Triaging in a Mass Casualty**</i>	Clinical Track	Rm. 101
	<i>Palliative Care in Limited Resource Settings**</i>	Clinical Track	Rm. 250
10:40 - 11:00	<b>Break 1</b>	Visit Exhibitors and Posters	Lobby/Exhibit Hall
11:00 - 11:50 AM	<b>Breakout Session 2</b>		
	<b>Topic</b>	<b>Track</b>	<b>Room</b>
	<i>Developing Sustainable Food Supplies in Low Resource Communities**</i>	W.A.S.H. (Water, Sanitation, Hygiene)	Rm. 203
	<i>Crossing Cultures Through Compassion**</i>	Serving the Forgotten	Rm. 101
	<i>Therapeutic Communication: What To Say In A Crisis**</i>	Non-Clinicians in the Clinical Setting	Rm. 258
	<i>Holistic Care: Caring for the Mind, Body and Soul***</i>	Personal Development	Rm. 257
	<i>Maternal Care in Limited Resource Setting**</i>	Clinical Track	Rm. 102
	<i>Caring for the Muslim Patient**</i>	Clinical Track	Rm. 224
	<i>Trauma Management in Limited Resource Setting**</i>	Clinical Track	Rm. 225/226
	<i>Chronic Disease Management in Limited Resource Setting**</i>	Clinical Track	Rm. 202
	<i>Ethical Issues in Global Health**</i>	Clinical Track	Rm. 250
11:50 - 1:00 PM	<b>Lunch - Visit Exhibitors and Posters</b>		Lobby/Exhibit Hall
12:30 PM	<b>Student Scholarship Photo</b>		Front Entrance
1:00 - 1:45 PM	<b>Plenary 2</b> - <i>Overview of The Sphere Project</i> - Greg Seager, RN, MSN		Auditorium

1:50 - 2:40 PM Breakout Session 3			
	Topic	Track	Room
	<i>Economic Development: A Public Health Issue**</i>	W.A.S.H. (Water, Sanitation, Hygiene)	Rm. 102
	<i>Displaced by Conflict: Partnering with Refugees and Displaced People Groups**</i>	Serving the Forgotten	Rm. 225/226
	<i>Creating a Medical Chart &amp; Taking a Blood Pressure</i>	Non-Clinicians in the Clinical Setting	Rm. 258
	<i>Travel Health &amp; Safety: A Team Approach</i>	Personal Development	Rm. 101
	<i>Ultrasound for Primary Care**</i>	Clinical Track	Rm. 203
	<i>W.A.S.H.**</i>	W.A.S.H. (Water, Sanitation, Hygiene)	Rm. 202
	<i>Completing an Eye Chart Exam/Assisting in the Pharmacy</i>	Non-Clinicians in the Clinical Setting	Rm. 257
	<i>Palliative Care in Limited Resource Settings**</i>	Clinical Track	Rm. 250
	<i>Chronic Disease Management in Limited Resource Setting**</i>	Clinical Track	Rm. 202
2:40 - 3:00 PM Break 2		Visit Exhibitors and Posters	Lobby/Exhibit Hall
3:00 - 3:50 PM Breakout Session 4			
	Topic	Track	Room
	<i>Developing Sustainable Food Supplies in Low Resource Communities**</i>	W.A.S.H. (Water, Sanitation, Hygiene)	Rm. 202
	<i>Embrace the Nations: An Example of Holistic Partnerships in the Refugee Community **</i>	Serving the Forgotten	Rm. 257
	<i>Therapeutic Communication: What To Say In A Crisis**</i>	Non-Clinicians in the Clinical Setting	Rm. 258
	<i>Holistic Care: Caring for the Mind, Body and Soul***</i>	Personal Development	Rm. 250
	<i>Critically Ill Pediatric Patient in Limited Resource Setting**</i>	Clinical Track	Rm. 225/226
	<i>Economic Development: A Public Health Issue**</i>	W.A.S.H. (Water, Sanitation, Hygiene)	Rm. 224
	<i>Crossing Cultures Through Compassion**</i>	Serving the Forgotten	Rm. 101
	<i>Triaging in a Mass Casualty**</i>	Clinical Track	Rm. 102
	<i>Ultrasound for Primary Care**</i>	Clinical Track	Rm. 203



## Friday Conference Schedule Continued...

\* Faith-based  
\*\* CE accredited

3:55 - 4:45 PM	Breakout Session 5		
	Topic	Track	Room
	<i>Caring for the Muslim Patient**</i>	Clinical Track	Rm. 202
	<i>Displaced by Conflict: Partnering with Refugees and Displaced People Groups**</i>	Serving the Forgotten	Rm. 250
	<i>Preparing to Go: What You Need to Know Before You Go</i>	Non-Clinicians in the Clinical Setting	Rm. 224
	<i>Travel Health &amp; Safety: A Team Approach</i>	Personal Development	Rm. 101
	<i>Trauma Management in Limited Resource Setting**</i>	Clinical Track	Rm. 225/226
	<i>Maternal Care in Limited Resource Setting**</i>	Clinical Track	Rm. 102
	<i>Triaging in a Mass Casualty**</i>	Clinical Track	Rm. 203
	<i>Ethical Issues in Global Health**</i>	Clinical Track	Rm. 257

## Saturday Conference Schedule

8:00 - 8:30 AM	<b>Plenary 3 - Go &amp; Teach</b> - Paul Larson, MD	Auditorium
8:30 - 11:20 AM	<b>Simulation Activity</b>	
11:30 - 12:00 PM	<b>Plenary 4 - From Rescue to Resilience</b> - Nicholas Cominellis, MD, MPH, DIMPH	Auditorium

**Conclusion of Conference**

-Breakout Session Topic *How Literacy Improves Health\*\** was replaced by *Caring for the Muslim Patient\*\**  
 -*Completing an Eye Chart Exam/Assisting in the Pharmacy* was removed from Breakout Session 1



Early Bird Registration for the  
2018 Humanitarian Health Conference is  
Available at the Bookstore

*Equipping Healthcare Professionals  
and Students to Serve the Forgotten*