

2014 Exploring Medical Missions Conference

Sticks in a Bundle Are Unbreakable



Equipping Healthcare Professionals & Students to Serve the Forgotten

The Institute for International Medicine

Welcome

It is a great joy to welcome you to the ninth annual INMED Exploring Medical Missions Conference!

I invite you to explore this year's theme - Sticks in a bundle are unbreakable. This Kenyan proverb embraces the discovery that the unity of like-hearted people and the multiplied strength of their individual efforts yield compelling results. In this light, we, with a passion for the health of our world's forgotten citizens, can realize progress - but only as we cooperate with one another.

Throughout the conference, we will explore the benefits of working in a multi-disciplinary healthcare team, apply best practices when working with cross-cultural patients, describe the common ethical dilemmas encountered when providing health services in a resource-poor community, list the common diseases found in resource-poor communities, describe the role of poverty in overall health, and apply appropriate clinical skills in a resource-poor setting.

My sincere hope is that you are inspired and equipped to serve the forgotten and that this event will challenge you to think inclusively, to learn in collaboration, to forge alliances, and to celebrate progress together in global health. Thank you for sharing in this marvelous journey.

Nicholas Comninellis

Nicholas Comninellis, MD, MPH, DIM&PH
President, Institute for International Medicine
Assistant Clinical Professor of Community &
Family Medicine
University of Missouri - Kansas City

Core Competencies:

- Provide patient-centered care
- Work in interdisciplinary teams
- Employ evidence-based practice
- Interpersonal and communication skills
- System-based practice



Nicholas Comninellis, MD

Table of Contents

Welcome.....	2
Sponsors.....	4
Supporters.....	5
Hosts.....	5
Speakers.....	6-13
Shuttle Schedule.....	13
Exhibitors.....	14-30
CME.....	31
Disclosures.....	32
Awards.....	33-34
Graceway Map.....	35-36
Schedule.....	37-39

INMED

The Institute for International Medicine (INMED) exists to equip healthcare professionals and



INSTITUTE FOR
INTERNATIONAL
MEDICINE

students to serve the forgotten. We are a nonprofit organization that offers didactic instruction in international health, diseases of poverty, and community health strategy in online and in-classroom courses as well as conferences. We also offer supervised international service-learning experiences for healthcare students and professionals at over 45 training sites in 20 low-resource countries.

Service Learning

Diplomas

International Medicine & Public Health Diploma

International Public Health Diploma

Alumni Opportunities

Alumni Service Program Fellowship



Check out inmed.us to browse our list of international training sites.

Courses

Hybrid Courses

International Medicine & Public Health Intensive Hybrid Course

International Public Health Intensive Hybrid Course

Online Self-Paced Courses

International Public Health
Diseases of Poverty
International HIV Medicine
Cross-Cultural Competency
Disaster Management
International Health Leadership

For more information, please visit inmed.us or contact us at:

INMED
6400 Prospect Ave, Suite 338A
Kansas City, MO 64132 USA

E-mail: office@inmed.us
Phone: 816-444-6400
Fax: 816-444-3060

Sponsors



Commercial Interest Support

Physician Resource Laboratories

Matec (Midwest Aids Training & Education Center)

Supporters

Uyiosa Aimiwu
Kate Alberts
Anonymous
Cecelia Babbott
Andy Bukaty
Troy Burns
Joe Cates
Nancy Crigger
Datcha Dorvil
Nancy Dye
Roy Elfrink
David Fieleke
Micah & Jennifer Flint
John Fontenot
Bill Gilbirds
Peter Greenspan
Reuel Gregory
Ted & Kim Higgins
Tom Hodge

Kevin Hubbard
Marty Kanne
Spencer Kerley
Ali Khezrian
Gary Kindell
Scott Kujath
Winston Manimtim
Allan Martin
Jose Martinez-Figueroa
Gary McEwen
David McKinsey
Andy Moyes
Scott Murphy
Cindy Obenhaus
Reginald Peake
Bruce Pfuetze
Don Philgreen
John Podgore
Rick & Jo Randolph

Dean Reeves
Sequita Richardson
Jesse Roberts
Steve Salanski
Stan Shaffer
Cindy Shumpert
Eleni Sourlis
Francie Stoner
Charles Sullivan
Glenn Talboy
Rory Tompkins
Bob Tung
Larry VanVleet
Mitch Voelker
Jon Wada
Vince Wait
Bill White
Audrey Williams
Gustav Wilde
Julie Wood

Hosts



INSTITUTE FOR
INTERNATIONAL
MEDICINE



Speakers



Jimmy Dodd is a Director of Cross International, a ministry supporting the world's most disadvantaged people through provision of food, shelter, and hope. A graduate of Wheaton College and Gordon-Conwell Seminary, Jimmy Dodd, for over twenty years, has galvanized the credibility of his message by personally partnering with colleagues in Haiti for that nation's development.



Paul Larson, MD is Director of Global Health Education at the UPMC St. Margaret Family Medicine Residency. Following training in Family Medicine and Tropical Medicine, he practiced for two years in Kapsowar, Kenya. Returning to the USA, he completed a MS in medical education, a fellowship in faculty development and teaches INMED students in Ghana or Kenya every year.



John Clements, MD, INMED Fellow, is an Ophthalmologist trained as a cornea specialist at Harvard. Dr. Clements is now serving as the Medical Director of the Boa Vista Eye Clinic in Angola, Africa. He is married to his wife, Lori, and they have three young boys.



Oscar Paulo, MD is a native of the nation of Angola in southern Africa. He received medical critical care training in Brazil, was the Medical Officer for the United States Embassy in Angola, and today leads an initiative to recruit and train healthcare personnel for the rural Angolan province of Uige.

Speakers



Abigail Rattin, MD, MPH serves in Uganda with Action International Ministries as the Medical Coordinator. Utilizing her training in Family Medicine and Public Health, and her experience as a mom of a special needs child, she provides direct clinical care and consults for vulnerable children and children with special needs.

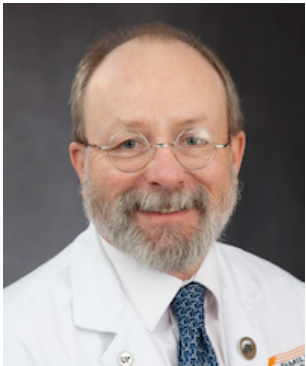

M. David Stockton, MD, MPH is Professor of Family Medicine and Director of the Travel Medicine Clinic at UTGSM Knoxville. Also a Fellow of the Academy of Wilderness Medicine and TN-1 DMAT, he has served with residents and medical students on international medical mission projects for over 30 years.



Nancy Crigger, PhD, ARNP is an Associate Professor of Nursing at Graceland University. For two decades she has led volunteer medical teams to Central America, and has been published extensively regarding her insights into cultural, ethical and best practices issues related to international service. Dr. Crigger is also a member of the INMED Board of Directors.



Peter Greenspan, DO is Associate Chairman, Department of OB-GYN, Truman Medical Center-Lakewood and Assistant Professor, University of Missouri-Kansas City School of Medicine. Dr. Greenspan, a messianic Jew and graduate of the Chicago College of Osteopathic Medicine, is a recognized authority on subjects of apologetics, medical ethics and human cloning.

Speakers



Ted Higgins, MD is a General and Vascular Surgeon at Research Medical Center. He has volunteered in the Dominican Republic each year since 1995, guiding the transition of his team from directly providing surgical care to training Dominican national physicians in surgical skills to serve their own people.



Don Philgreen, MD, a certified Advanced Life Support in Obstetrics (ALSO) instructor, is a faculty physician at the Research Family Medicine Residency. Don's medical experience includes four years service on the Gila River Indian Reservation. In 2004 he was named the Missouri Family Physician of the Year.



Lori Clements is mother of three young boys and facilitator of a ministry to blind persons in the nation of Angola, southern Africa, where she and her husband John have lived since 2011. Lori strives to make her children know they are a priority, as she balances family and outreach to the underprivileged.

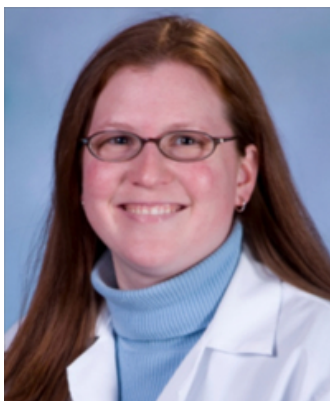

Lisa Mohrman, MD practices General Surgery in St. Louis. Dr. Mohrman is the INMED 2012 – 2013 Fellow and served in Ghana for a year as a surgeon. She completed the INMED Diploma in International Medicine and Public Health during medical school in Cameroon. She has also participated in short term trips to the Dominican Republic and Mexico. She is a graduate of the University of Notre Dame and the University of Missouri – Columbia Medical School.

Speakers



Brad Gautney, PNP, MPH, Founder and President of GHI, has worked with pediatric HIV programs in Haiti and East Africa for the past several years. His experience in designing and implementing HIV Early Infant Diagnosis programs for HIV exposed infants has allowed him to identify crucial gaps in the prevention of HIV, as well as the provision of comprehensive care for those babies exposed to HIV.



Jeff Adams is the Senior Pastor of Graceway Church. Previously, Jeff spent ten years pastoring in Latin America with his wife Cheryl and daughters, Sarah and Rebekah. He was gifted with the Spanish language while abroad and keeps it up by sharing his passion for the Word of God in English and Spanish at Graceway and as an international conference speaker.



Jay Grimwood, is the International Development Pastor of Graceway Church and has led international teacher training teams to South Korea, the Philippines, and Mongolia. He has also been involved with educational and humanitarian programs in Egypt, Zambia, Japan, Taiwan, and Kurdistan.



Dan Spurgeon and his wife, Julie, are the parents of three children (Lauren, Amy and Stephen). They reside in Newnan, GA. As "permanent – part time" mission workers with Operation Mobilization, their family has experience in non-medical contributions to medical missions in eight different countries since 2007.

Speakers



James Fyffe works as an Emergency Room Nurse, but his true passion is encouraging others to be fully engaged in the mission of God. He did that serving in Central America for two years, and intermittently since then. He is now preparing to move to Asia to continue that work as he partners with an existing ministry at a local hospital.



Dr. Stan Shaffer is a graduate of UMKC School of Medicine and Saint Paul School of Theology. He is a Neonatologist, working in Kansas City at St. Luke's Hospital, and in Haiti with Episcopal Relief and Development, the Global Birthing Home Foundation, and the Helping Babies Breathe Program. He is co-founder of Haitian Episcopal Learning Partnerships and Maison de Naissance, in Torbeck, Haiti.



Dr. Pholaphat Inboriboon is an Emergency Medicine Physician at Truman Medical Center. He serves as the Assistant Program Director of the residency and as the Director of International EM programs. He completed residency at the University of Illinois at Chicago and completed an International EM fellowship at the University of Rochester.



Kristell Willmer is a Family and Pediatric Nurse Practitioner who has served internationally in fourteen countries. She has a heart for mentoring others to work internationally, and helped start sustainable medical clinics in Kenya and Haiti. She attended the INMED intensive course in 2010 and completed her fellowship at the Ghana Baptist Medical Center in 2012.

Speakers



Dr. Scott Colliton received his undergraduate training at Arizona State University and North Dakota State University. He obtained his medical degree from the University of North Dakota. His pediatric training took place at the Children's Mercy Hospitals and Clinics in Kansas City, MO, and currently is on staff there in the section of General Pediatrics. He has a special interest in children with special health care needs, as well as, International Adoption Medicine.



Dr. Curtis Gongwer is a family physician at the South Bend Clinic. He attended Indiana University School of Medicine and the Liverpool School of Tropical Medicine. In addition, he holds a certificate from the American Society of Tropical Medicine and Hygiene (CTropMed®). Dr. Gongwer has practiced medicine in Nepal, Kenya, and Ghana. He currently serves as assistant director for Crosspoint Global Health, a non-profit community health ministry.



Dr. Gale Oleson completed his Dermatology residency at the Mayo Clinic in 1986 following a rotating/family practice internship in Sioux Falls, South Dakota. Since completing his training, he was in private practice in Jackson County until retiring from private practice at the end of 2012. During that time, his practice emphasis was in cosmetic and surgical dermatology.



Dr. Joseph LeMaster. Following residency in 1990, Joe and his wife, Judy, first served at Okhaldhunga Hospital in eastern Nepal, a 32-bed facility that provided the only medical care for 300,000 people. During a furlough, Joe completed a Masters in Public Health in Developing Countries at the London School of Tropical Medicine. Over the next ten years, he also promoted maternal-child health through the Okhaldhunga Primary Health Care Programme in Nepal, and conducted research on leprosy with The Leprosy Mission and Anandaban Leprosy Hospital.

Speakers



Lloyd Cleaver, D.O. is the founder of the Cleaver Dermatology Clinic. Dr. Cleaver is a Board Certified Dermatologist and in Mohs Surgery. He is a graduate of the INMED Diploma in International Medicine and Public Health. Dr. Cleaver has extensive international medicine experience.



Roy Moran, Th.M. Born from the soil of conservative fundamentalist theology, Roy possesses a “bleeding edge” mentality about seeing the Great Commission achieved in his lifetime. Having pioneered the Hybrid Church model, he is now helping churches world wide understand and implement disciple-making movement strategies alongside very traditional churches.



Patrick Railey, MD, is Director of Operation Mobilization Medical Ministries, an international Christian mission agency providing medical, dental, public health, relief, and development work in more than 100 countries. Dr. Railey is a leader in HIV prevention and protection of newborns, advocating de-stigmatization and compassion for those who are afflicted.



John Gibson, MD, is Program Director of the International Medicine Fellowship at the University of Texas Southwestern Health Sciences Center/John Peter Smith Hospital. He lived in Thailand from 1984-2004 training medical personnel and providing care for marginalized people throughout the nation. Dr. Gibson is a certified Diagnostic Ultrasound Instructor.

Speakers



Cameron Gongwer, MD, MPH, graduated from Indiana University School of Medicine, the London School of Hygiene and Tropical Medicine, and the University of Ghana School of Public Health. In 1999 he became the first physician to serve at Ankaase Methodist Hospital in Ghana, West Africa where he mentored INMED students beginning in 2005. After 14 years in Ghana, Dr. Gongwer now coordinates global health outreaches with The Mission Society and practices family medicine at the South Bend Clinic.

Shuttle Schedule

(Between Four Points by Sheraton and Graceway)



Thursday, May 29th — 7:45 am, 8:15 am, 5:15 pm, 5:45 pm

Friday, May 30th — 7:45 am, 8:15 am, 5:45 pm, 6:00 pm, 8:15 pm

Saturday, May 31st — 7:15 am, 7:30 am, 12:15 pm, 12:30 pm

A Special Thank You to the Following People

Graceway Staff Team

Michelle Moorman
INMED Intern

Silber Spoons Catering

Jonna Deng
INMED Intern

Tropical Medicine
Actors

Irene Sugut
INMED Intern

Conference Volunteers

Exhibitors



Website: www.gobgr.org
 Contact: Rebekah Naylor, MD
 Email: rnaylor@gobgr.org
 Address: 402 BNA Drive, Suite 411, Nashville, TN 37217

Booth 101

Baptist Global Response is an international relief and development organization connecting persons in need with persons who care. One avenue to do this is through medical mission opportunities all over the world.



www.failefoundation.org
 Cindy Shumpert, MD
rnoodles@bellsouth.net
 1363 Mount Alto Road, Rome, GA 30165

Booth 102

The George Faile Foundation has a strong commitment to make a difference in the lives of the people of Northern Ghana. We support Baptist Medical Centre in providing spiritual and health care to those in need in this area. We believe that our service earns a hearing for the transforming gospel of Jesus Christ.

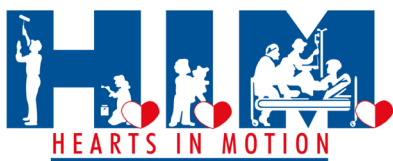

Website: www.heartsinmotion.org
 Contact: Cara Hulse, RN
 Email: information@heartsinmotion.org
 Address: 1834 45th Street, Munster, IN 46321

Booth 103

The mission of **Hearts In Motion** is to provide care and medical treatment for children, families, and communities through its programs and sponsorships in the U.S., and Central and South America. An additional goal is to provide opportunities for individuals to participate in short-term mission experiences. The impact of the trip experience on each team member is at least as great as the impact on the lives of the people we touch. Many lives are changed. Hearts In Motion works to complement resources already in place while respecting the culture of those whose lives it touches. Hearts In Motion accomplishes this with compassionate volunteers who unite their efforts and talents.

Exhibitors



Website: hfckc.org
 Contact: Nathan Jackson
 Email: admin@hfckc.org
 Address: 3027 Prospect Ave, Kansas City, MO 64128

Booth 104

Hope Family Care Center (HFCC) is a non-profit, faith-based family practice providing quality primary health care to our underserved community on Kansas City, Missouri's east side. Our community is a medical desert with limited health care options, and HFCC is the only primary care provider operating within its primary service area. Our mission is to honor God by providing quality, personal healthcare. We envision all residents of our east side community receiving quality, personal health care, enabling them to achieve optimum health. Preventive health care will become normal, regardless of one's income. We believe that sustained high-quality, personal health care will contribute to the transformation of our community.



Website: bmdmi.org
 Contact: Will Holder
 Email: will@bmdmi.org
 Address: 11 Plaza Dr., Hattiesburg, MS, 39402

Booth 105

Baptist Medical & Dental Mission International (BMDMI) meets the physical and spiritual needs of the poor living in Honduras, Nicaragua and Nepal, primarily through short-term medical and evangelical mission volunteers from all across the U.S. These teams may also participate in construction and food distribution projects. In addition, surgical teams travel to the BMDMI Baptist Hospital in Honduras to perform various surgeries each year. You can make a difference by serving on a team! www.bmdmi.org.

Friday and Saturday Only

Register for the 2015 EMMC

Only \$100

Purchase 2015 Registration at the Conference Bookstore
 No Refunds Available

Exhibitors



Website: medsend.org
Contact: Jessica Schneider
Email: jessica@medsend.org
Address: 999 Oronoque Lane, Stratford, CT 06614

Booth 106

MedSend enables Christian healthcare missionaries to serve people in need around the world by making their monthly educational loan payments while they serve. Our goal is to free healthcare missionaries to respond to God's call to service by removing educational debt as an obstacle. Come by our booth and tell us about your calling. We are giving away money.

“MedSend makes it possible for us to fulfill our ministry calling to full-time, long-term medical missions!”

– Daniel Galat, MD, Director, Department of Orthopedic Surgery,
Tenwek Hospital, Kenya



Called to healthcare missions?

MedSend can make your education loan payments while you serve.

Find out more at www.medsend.org

Exhibitors



Website: saintlukeshealthsystem.org

Contact: Audrey Hill

Email: amhill@saint-lukes.org

Address: 10920 Elm Ave, Kansas City, MO 64134

Booth 107

Each year, **Saint Luke's Health System** employees and physicians donate their time to national, international, and local missions engaged in a variety of activities to support underserved and distressed communities. To encourage, recognize and support our volunteers, we have established the office of Global Health, which engages in the following activities: 1) facilitates donations of supplies and equipment, 2) provides travel medicine services to employees and their families, 3) serves as a clearinghouse for information and resources on medical mission and sending organizations, and 4) recognizes exceptional service by our employees and physicians with an annual award for the Global Health Volunteer of the Year.



Website: www.hearttoheart.org

Contact: Sarah Warfield

Email: sarah.warfield@hearttoheart.org

Address: 401 S. Clairborne Rd, Suite 302, Olathe, KS 66062

Booth 108

Heart to Heart International has been creating a healthier world since 1992. Our mission is to improve global health through initiatives that connect people and resources to a world in need. Through our mobilization efforts, we provide medical education, deliver medical aid, respond to people in crisis and address community-health concerns around the globe.



Website: www.jacohd.org

Contact: Janet Pace

Email: janet.pace@tmcmcd.org

Address: 313 S Liberty, Kansas City, MO 64050

Booth 109

The travel nurses at the **Jackson County Health Department** provide prospective travelers with counseling as well as immunizations for your particular destination. During the pre-travel consultation, the travel nurse will provide clients with the most current data obtained from the Centers for Disease Control specifically for your travel destinations.

Exhibitors



Booth 110

Website: www.allindiamission.com

Contact: Hope Howe

Email: hope@allindiamission.com

Address: 11252 Strang Line Rd., Lenexa, KS 66215

All India Mission-bringing the love and hope of Jesus to northeastern India, opened the beautiful Shanti Bhavan Medical Center in February 2014. The new state-of-the-art, modern medical hospital is seeking to connect with specialized doctors and nurses who are interested in short-term mission work.

Not sure which INMED offering you qualify for?

Visit inmed.us/prospective-learners to find out.

Discover opportunities for:

- Medical Students (Before Clinical Rotations)
- Medical Students (After Clinical Rotations)
- Resident Physician
- Attending Physician
- Nursing Student Undergrad
- Nursing Student Adv Practice
- Nurse
- Nurse Advanced Practice
- Pharmacy Students (Before Clinical Rotations)
- Pharmacy Students (After Clinical Rotations)
- Pharmacist
- Physician Assistant Students (Before Clinical Rotations)
- Physician Assistant Students (After Clinical Rotations)
- Physician Assistants
- Public Health Student
- Public Health Specialist
- Undergraduate Student
- Healthcare Admin Student
- Healthcare Administrator
- Physical/Occupational Therapy Student
- Physical/Occupational Therapist
- Dental Students (Before Clinical Rotations)
- Dental Students (After Clinical Rotations)
- Dentist
- Non-Healthcare Personnel
- Other Healthcare Personnel



Exhibitors



Website: www.simusa.org

Contact: Bob Murray

Email: bob.murray@sim.org

Address: 39923 W Huron River Drive, Romulus, MI 48174

Booth 111

SIM serves in 65 countries with missionaries from over 50 countries and has medical ministries in Africa, South America, Europe, and Asia.



Website: www.equipinternational.org

Contact: Dr. Larry L. Litke

Email: equip.edu@gmail.com

Address: 126 Rock House Rd, Marion, NC 28752

Booth 112

Equip International is a Christian organization that seeks to share the gospel of Jesus Christ through the training and sending of missionaries throughout the world. Equip offers practical training for those seeking to minister through medicine and other appropriate technologies in developing countries. Nurses taking Equip's two-week Missionary Medicine Intensive course (MMI) can receive CEU credits through the North Carolina Nurses Association. Physicians and mid-level medical practitioners completing our four-day Missionary Medicine for Physicians course (MMP) can receive CME credits through a joint sponsorship with CMDA. Visit our website for more information.

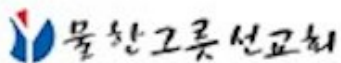

Website: www.givetodrink.org

Contact: Daniel Kwon

Email: biblicalhot@gmail.com

Address: P. O. Box 9809, Kansas City, MO 64134

Booth 113

A Cup of Water International's first purpose in ministry is to reach and reduce the number of unreached people groups. This is done primarily by using the provision of clean water to open their minds and hearts to the gospel – the real clean living water. We ask for your prayers for this ministry as we are blessed to use the gifts and training God has given us.

Exhibitors



Booth 114

Website: www.childrensmercy.org

Contact: Shirley Molitor-Kirsch

Email: smolitor-kirsch@cmh.edu

Address: 2401 Gillham Road, Kansas City, MO 64108

Healthy Departures, the International Travel Medicine Clinic at Children's Mercy, is the only travel clinic in the Kansas City region dedicated exclusively to the unique needs of children and teens as well as the adults traveling with them. Our physicians and nurses are experts not only in which vaccinations and medications are recommended for travel but will also customize your health plan based on your medical history and itinerary. They will provide counseling and information on health care needs, disease prevention and health and safety considerations wherever you may be traveling. Backed by nationally-recognized expertise of Children's Mercy Hospital, families can be assured there will be expert consultation with subspecialty services when needed.



Booth 115

Website: www.omf.org/us

Contact: Neil O. Thompson

Email: medicalmissions@omf.org

Address: 10 W. Dry Creek Circle, Littleton, CO 80120

OMF International serves the peoples of East Asia, proclaiming and showing the love of Christ through compassionate medical care. Our founder, J. Hudson Taylor was a physician who pioneered spiritual and physical healing to the peoples of China in the mid-nineteenth century. That ministry continues. Visit us to see how you can be involved as a medical professional in East Asia.

Exhibitors



Booth 116

Website: www.afctravel.com

Contact: Anthony Hilden

Email: anthony@afctravel.com

Address: 511 East Travelers Trail, Burnsville, MN 55337

AFC Travel offers discounted international airfare for nonprofits and students. Please contact us at Anthony@afctravel.com for a quote on airfare.

Mission: To honor God by providing quality, personal health care



Linwood Shopping Center
3027 Prospect Ave.
Kansas City, MO 64128

Hope Family Care Center is a primary-care facility providing quality personal healthcare. All patients are welcome and we accept Medicaid, Medicare, and commercial insurance. Uninsured patients are charged a small fee. We focus on adult and pediatric primary care services and have an onsite lab for any needed tests.



Your Support

How you can help HFCC grow and improve health in Kansas City:

1. Financial Support: one-time or monthly donations
2. Be a patient: Commercial insurance helps fund the operational gap in caring for the uninsured
3. Networking: Connect HFCC with strategic partnerships
4. Volunteer: Medical and office volunteers needed
5. Pray for our board, staff, volunteers and patients

hfckc.org

*Thank You
AFC Travel
for providing
bags for the
INMED
Bookstore.*

*Stop buy the
conference
bookstore to
check out our
global health
resources!*

Exhibitors



Website: www.globusrelief.org

Contact: Vy Lake

Email: vlake@globusrelief.org

Address: 1775 W. 1500 S., Salt Lake City, UT 84104

Booth 117

Globus Relief is a medical resource humanitarian organization. We are committed to partnering with other charities, corporations, and government agencies working to improve the delivery of healthcare across the world. We accomplish the improvement of healthcare through the following five key deliverables: 1. Assessment 2. Consulting 3. Acquiring, Packaging and Distributing (APD) 3. Providing Bio-Tech Solutions 4. Training by reducing unnecessary duplication of efforts among our partners and 5. working to produce a synergistic environment that enhances all our efforts and magnifies social impact. We will continually work to improve healthcare worldwide. Our efforts will be marked by upgrading medical facilities, supplies and standards of delivery in the humanitarian supply chain. We are working toward a world where basic wellness is available to everyone.



Website: WaterStep.org

Contact: Doug Lark

Email: doug.lark@waterstep.org

Address: 625 Myrtle St., Louisville, KY 40208

Booth 118

WaterStep (a non-profit organization) believes that water is a gift from God, that safe water is a tool for compassion, and that providing access to safe water is the first step to a higher quality of life. WaterStep focuses its efforts and resources on these key solutions: (1) technology in water purification and hand pump repair, (2) health and hygiene education, (3) community development approaches, and (4) disaster relief and emergency management response.

Exhibitors



Booth 119

Website: www.restoringvision.org
 Contact: Mark Sachs
 Email: mark@restoringvision.org
 Address: 222 Ridgewood Drive San Rafael, CA 94901

RestoringVision.org is a non-profit that supplies new reading glasses and sunglasses to groups going to, or with clinics in developing countries. Since 2003, they have provided over 2M glasses to over 800 groups.



RESTORINGVISION.ORG

RestoringVision.org is a non-profit providing new, high quality, affordable readers and sunglasses for medical, vision, faith-based and general philanthropic groups delivering "the gift of sight" to those people who would otherwise lack access or resources.

Contact Us:

Mark Sachs,
 President and Founder
mark@restoringvision.org

 twitter.com/RestoringVision

 facebook.com/RestoringVision

Get glasses, dispensing info and help on our website:
www.restoringvision.org



A huge problem with a simple solution

Adding RestoringVision's eye care component to your existing mission project is **easy**. We provide well-balanced inventory of **new readers** and simple "how-to" instructions so that a few **untrained volunteers** can distribute glasses to 300-400 people in one day. By simply bringing along an 18 lb. package of 300 reading glasses in your luggage, you can have a **dramatic and immediate** impact on peoples' lives.

Exhibitors



Website: www.ehaususa.org
 Contact: Howard Searle, MD, MPH
 Email: hsearle@ehaususa.org
 Address: 215 N Arlington Heights Rd., Arlington Heights, IL 60004

Booth 120

EHA (USA) exists to grow prayer and financial support for the ministries of Emmanuel Hospital Association, an indigenous medical mission located in underserved areas of North India. EHA serves the poor and marginalized through 20 hospitals, 41 community health and development projects plus thematic ministries such as palliative care, disaster management, mental health, mainstreamed care of the handicapped, etc.



"I loved working with EHA! As committed, capable Christian medical professionals, they make significant sacrifices to care for the poor and proclaim Christ."

EHA missionary and
 University of Illinois
 Medical School Faculty

SERVE IN INDIA

The Emmanuel Hospital Association affords wonderful opportunities for service at any of its 21 hospitals and 40 community development projects. Why not join us?

To learn more visit
www.EHAUSA.org or
 call 1-888-893-2654.



EMMANUEL
 HOSPITAL ASSOCIATION (USA)

INMED Book, 2nd Edition

\$35



*Available at the
 Conference
 Bookstore*

Exhibitors



Booth 121

Website: globalbirthinghomefoundation.org

Contact: Jim Grant

Email: jim@maisondenaissance.org

Address: 5000 W 134th St., Leawood, KS 66209

Maison de Naissance, (MN), "Home of Birth," sponsored by Global Birthing Home Foundation, is a maternity center in Haiti that provides high quality medical care and ongoing community oriented support. Our mission is to significantly reduce maternal and infant mortality rates in Haiti, where they are among the highest in the world. MN has delivered over 4,700 healthy babies since 2004, without a single maternal mortality.



|| *Established in 2004 by two Kansas City physicians,
Dr. Elizabeth Wickstrom & Dr. Stan Shaffer* ||

**OUR MISSION IS TO SIGNIFICANTLY
REDUCE MATERNAL AND INFANT
MORTALITY RATES IN IMPOVERISHED
COMMUNITIES.**



Disaster Response Handbook

\$10

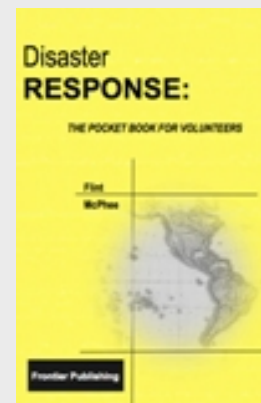

*Available at the
Conference Bookstore*

Exhibitors



Website: www.accelartec.com

Contact: Al Hedrick

Email: al@horizonglobalmarketing.com

Address: 4901 West 136th St., Leawood, KS 66224

Booth 122

Horizon Global Marketing (HGM) is a business as mission (BAM) Company providing products that improve the quality of life to the third world and impoverished people groups that maximizes Kingdom return. HGM distributes the following products: US Pharmaceuticals, Health Care Products, Medical Equipment and Supplies, Water Filters, Solar Products and Systems, Food Products and Seeds.



Website: www.mmfworld.org

Contact: Meg Duggan

Email: meg@mmfworld.org

Address: 8363 Melrose Drive, Lenexa, KS 66214

Booth 123

Medical Missions Foundation provides aid to indigent people of developing and economically depressed countries throughout the world. We provide reconstructive surgery and rehabilitation for children and adults, and ensure ongoing medical care by teaching local health care providers and providing supplies and equipment.



Website: www.researchresidency.com

Contact: Billie Gould

Email: Billie.Gould@hcamidwest.com

Address: 6675 Holmes #450, Kansas City, MO 64131

Booth 124

Research Family Medicine Residency is a community-based program in Kansas City, MO offering diverse patient base & strong inpatient experience in a tertiary care hospital & outstanding obstetrics experience with optional OB & Integrative Medicine Tracks. Opportunities for Medical Mission rotations. Clinic is NCQA Level 3 Patient Centered Medical Home. Our program is known for a nurturing environment & quality faculty. Visit www.researchresidency.com

Exhibitors

Booth 125



Website: www.5starworldwideins.com

Contact: Cecille Brechin

Email: 5starww@iwic.net

Address: 3015 E New York ste A2-266, Aurora, IL 60504

5 Star Worldwide Insurance plans offer protection when traveling outside your home country. Short term and long term policies are available. Emergency evacuation and emergency assistance 24 hours a day are included in all plans. 30+ years experience; customer testimonials available. Providing 5 Star Service to every customer.

.....
**5 STAR WORLDWIDE
 INSURANCE**

Individual Insurance
 5 Star Exclusive Plans
 Group Plans with Special Rates
 USA Health Insurance
 Trip Cancellation

www.5starworldwideins.com
Toll Free: 855 499-9915
 email: 5starww@iwic.net

Providing
 long term & short term
 worldwide insurance
 protection!

All plans include Emergency
 Evacuation / Repatriation

Exhibitors



MISIÓN DE CANDELILLA

Changing Lives on
Both Sides of the Border

Website: misiondecandelilla.org

Contact: Curtis Allerkamp

Email: sallerkamp@beecreek.net

Address: 888 White Oak Rd., Fredericksburg, TX 78624

Booth 126

Mision de Candelilla is a non-profit organization which began taking doctors, nurses, and anyone willing to serve across the Rio Grande into Northern Coahuila, Mexico in 1986. It now serves ten rural villages with medical clinics, building projects, and evangelism. The trips are five to six days in length. We are committed to this region of Northern Mexico and building lasting relationships with our Mexican neighbors.



Website: healthservicecorps.org

Contact: Greg Seager

Email: greg@healthservicecorps.org

Address: PO Box 132 Fruitvale , TX 75127

Booth 127

The Christian Health Service Corps (CHSC) is a mission sending organization created to equip, train, support and send missionary healthcare providers to serve the poor around the world. CHSC is the only mission organization specifically created to send health professionals to mission hospitals and health programs for periods of more than two years.



Website: www.thesendingproject.org

Contact: Clint Hall

Email: clint.hall@thesendingproject.org

Address: 12480 S. Black Bob Rd. Olathe, KS 66062

Booth 128

The Sending Project exists to build missional awareness, community, and collaboration among a diversity of churches. We imagine hundreds of churches working together...working in unity, working strategically, joining forces to eliminate physical and spiritual poverty in the world. We imagine it every day. And we believe it can happen.

Exhibitors

Booth 129



Website: www.petinternational.org
 Contact: Von Driggs
 Email: driggsv@petinternational.org
 Address: 503 E. Nifong Blvd. #186, Columbia, MO 65201

Our mission: **Personal Energy Transportation (PET)** International seeks to reflect the love of Jesus Christ by bringing the gift of mobility and dignity to those in developing countries who are unable to walk. PET International main objectives: promotion of PET vehicles, coordination of PET production sites, and assistance in the dissemination of vehicles to international agencies/sponsors.

The PET® Mobility Project seeks to reflect the love of God by bringing the gift of mobility and dignity to those in developing countries who are unable to walk.



**PET International:
 Gift of Mobility**



@GiftofMobility



Did You Know?

INMED offers training courses in

Helping Babies Breathe

and

Ultrasound for Low-Resource Healthcare

throughout the year.

Sign up online for an upcoming course at www.inmed.us

Exhibitors

Booth 130



Booth 130 - OM Medical Ministries
Website: ommedicalministries.com
Contact: Patrick Railey
Email: docrailey@gmail.com
Address: 285 Lynwood Avenue, Tyrone, GA 30290

OM Medical Ministries seeks to further the Kingdom of God through demonstrating His love via the gift of medicine. We desire to connect people wanting to serve into opportunities to plant or strengthen local churches. This is done through provision of free, primary care clinics in areas of need. Both medical and non-medical people are greatly needed for every outreach.

Friday and Saturday Only

**Register for the
2015 EMMC**

Only \$100

Purchase 2015 Registration
at the Conference Bookstore
No Refunds Available

Continuing Education

PHYSICIANS

Institute for International Medicine is accredited by the Missouri State Medical Association to provide continuing medical education for physicians.

Pre-Conference (Thursday, May 29)

The Institute for International Medicine designates this live activity for a maximum of 6 AMA PRA Category 1 Credit(s)[™]. Physicians should claim only the credit commensurate with the extent of their participation in the activity.

Conference (Friday, May 30 – Saturday, May 31)

The Institute for International Medicine designates this live activity for a maximum of 9.25 AMA PRA Category 1 Credit(s)[™]. Physicians should claim only the credit commensurate with the extent of their participation in the activity.

NURSES

Health and Human Services at JCCC is approved as a provider of continuing education by the Kansas State Board of Nursing. These course offerings are approved for the designated contact hours applicable for RN, LPN or LMHT relicensure. Kansas State Board of Nursing approved provider number LT00027-0549.

Pre-Conference (Thursday, May 29)

6 continuing nursing education hours (contact hours) may be awarded if participants attend all continuing education sessions of this program.

Conference (Friday, May 30 – Saturday, May 31)

9 continuing nursing education hours (contact hours) may be awarded if participants attend all continuing education sessions of this program.

* Nurses must attend the entire event to receive credit. No partial credit will be issued.

PHARMACISTS

The Continuing Education Committee of the Board of Pharmacy has reviewed and approved an application for continuing education programs for the 2014 EMMC.

Program Number: 2014-04-01

Contact Hours: 9.25 hours

Date: April 18, 2015

Conference Speaker Disclosures

Planning Committee Disclosures::

Nicholas Comninellis, MD, DIM&PH	INMED	Nothing to Disclose
Micah Flint, MPA, DIPH	INMED	Nothing to Disclose
Donna Gum, RN, MSN	INMED	Nothing to Disclose
Don Philgreen, MD	INMED	Nothing to Disclose
Penny Shaffer, RN	JCC	Nothing to Disclose

Speaker Disclosures::

James Fyffe, RN	North KC Hospital	Nothing to Disclose
Nicholas Comninellis, MD, DIPH	INMED	Nothing to Disclose
John Gibson, MD	JPS	Nothing to Disclose
Oscar Paulo, MD	Angola Physician	Nothing to Disclose
Lisa Mohrman, MD	INMED Fellow	Nothing to Disclose
Cameron Gongwer, MD	Crosspoint Global Health	Nothing to Disclose
Ted Higgins, MD	INMED	Nothing to Disclose
Nancy Crigger, PhD, ARNP, RN	INMED	Nothing to Disclose
Don Philgreen, MD	INMED	Nothing to Disclose
Peter Greenspan, DO	INMED	Nothing to Disclose
Roy Moran	INMED	Nothing to Disclose
David Stockton, MD	University of TN	Nothing to Disclose
Abby Rattin, MD	Uganda Missionary	Nothing to Disclose
John Clements, MD	Angola Missionary	Nothing to Disclose
Lori Clements	Angola Missionary	Nothing to Disclose
Scott Colliton, MD	CMH	Nothing to Disclose
Brad Gautney, NP	Global Innovations	Nothing to Disclose
Lloyd Cleaver, MD	Private Practice	Nothing to Disclose
Stan Shaffer, MD	Neonatal Physician	Nothing to Disclose
Paul Larson, MD	UPMC	Nothing to Disclose
Joseph LeMaster, MD	KU Med	Nothing to Disclose
Crystal Murphy, RN, CNM	Private Practice	Nothing to Disclose
Lindsey Hill, RN, CNM	Private Practice	Nothing to Disclose
Gale Oleson, MD	Private Practice	Nothing to Disclose
Dan Spurgeon	OM Medical	Nothing to Disclose
Curtis Gongwer, MD	Crosspoint Global Health	Nothing to Disclose
Kristell Willmer, RN, FNP-C, DIMPH	Point Loma Nazarene Univ.	Nothing to Disclose
Patrick Railey, MD	Private Practice	Nothing to Disclose
Jay Grimwood	Graceway	Nothing to Disclose
Jimmy Dodd	Cross International	Nothing to Disclose
Charlie Inboriboon, MD	TMC	Nothing to Disclose

Awards

Abigail Rattin, 2014 INMED International Medicine Award Recipient



Abigail Rattin, MD, MPH, is Medical Coordinator of Action International Ministries. A family physician with public health training at University of Massachusetts-Amherst. Since 2010 Dr. Rattin has been living and serving in the nation of Uganda, eastern Africa. From her particular experience as mother of a special needs child, she provides direct clinical care, consulting and advocacy for vulnerable children and those children with special needs. In this context she consistently brings to light not only the gravity of such disabilities in Africa, but also effective and culturally appropriate means of preventing and optimizing life and functionality for these individuals.

Paul Larson, 2014 INMED International Healthcare Preceptor Award Recipient



Following formal training in family medicine and tropical diseases, Paul Larson, MD, practiced for two years at Kapsowar Hospital in Kenya in association with the Africa Inland Church. Returning to the USA, he completed graduate studies in medical education and a fellowship in faculty development. Today, Dr. Larson is Director of Global Health Education at the University of Pittsburgh Medical Center's St. Margaret Family Medicine Residency. He also continues to rigorously apply his teaching skills by supervising INMED Diploma students at the Baptist Medical Center in northern Ghana, where by personal example and by instruction he casts a vision for the next generation of globally minded healthcare leaders.

John & Lori Clements, 2014 Comninellis Award for Compassionate Service to Humanity Recipients



Preventable blindness is common in Angola, where childhood infections and older adult cataracts disable otherwise healthy people. In 2011 John and Lori Clements responded to this crisis and a clear call from God upon their lives. John, a fellowship-trained ophthalmologist, became an INMED International Medicine Fellow, serving at the Boa Vista Eye Center. John took the long-range approach, and in addition to caring for patients one-by-one he also organized a training program for Angolan national physicians to multiply these skills. Meanwhile, Lori Clements, in addition to raising three boys, took a lead in the Association for the Blind, providing craft training for those with more permanent disabilities.

Awards

Baptist Global Response, 2014 INMED Humanitarian Crisis Response Award Recipient



Organized in 2006, Baptist Global Response connects people who care with people in need - those suffering from acute problems like disasters, wars, and epidemics, as well as chronic ones including poverty, hunger, and poor health. Their more recent project sites include South Sudan where ongoing conflict created tens of thousands of refugees. BGR is drilling boreholes and providing thousands of families with safe drinking water and storage containers. BGR is also active in the Syrian Crisis, where those fleeing the escalating violence arrive in surrounding countries with no provisions. BGR is providing food parcels and hygiene kits to these families in need.

Hayley Stolzle, 2014 INMED HIV Leadership Award Recipient



Hayley Stolzle, MPH, a graduate of the University of Kansas School of Public Health, in 2011 took her skills to the southern African nation of Botswana. In concert with the Peace Corp, she began serving the Botswana Ministry of Health in delivering to 12 villages health education on teenage pregnancy, sexual abuse, HIV prevention, and safe male circumcision, and empowerment of women. Her particular passions surround addressing the vulnerability of girls and women to HIV, men as partners in sexual health, safe sex negotiation skills and gender equality. Illustrating her commitment to the Botswana people, she has also become highly proficient in Setswana, that nation's dominant language.

Oscar Paulo, 2014 INMED National Healthcare Service Award Recipient



Oscar Paulo is a physician in his home nation of Angola, located in southern Africa. Following a forty-year civil war, Angola has the lowest health status on the entire continent. In 1989, in cooperation with the Angola Baptist Convention, Dr. Paulo founded a humble medical clinic caring for the poor in the suburbs of Luanda, Angola's capital city. Recognizing the shortage of trained healthcare personnel in the northeast region of Angola, Dr. Paulo also established a scholarship program to select and train Angolan medical students, personally mentoring them in professional, spiritual, and personal life skills for the unique challenges of this proud nation.

Graceway - Main Floor

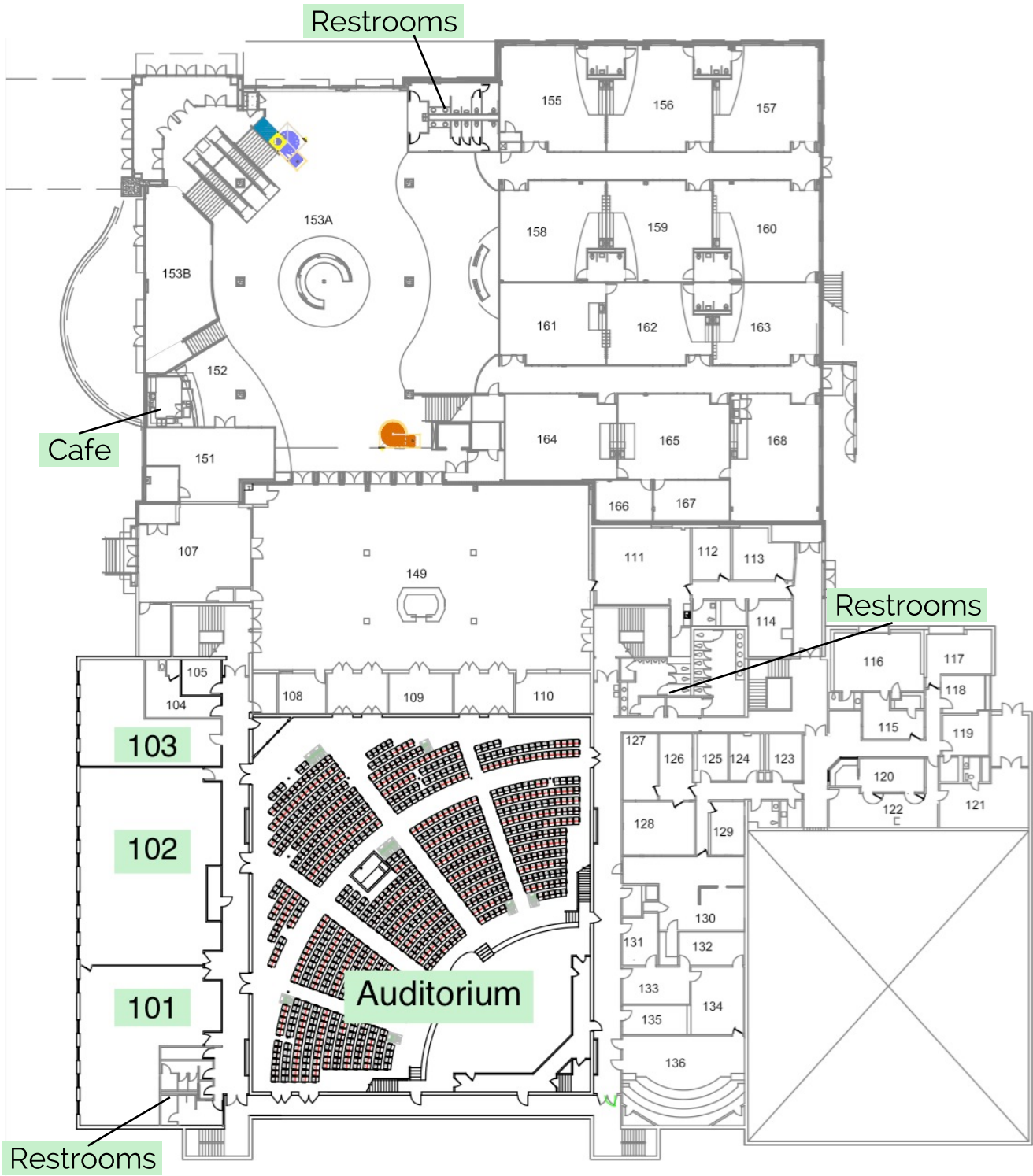

Graceway - 2nd Floor

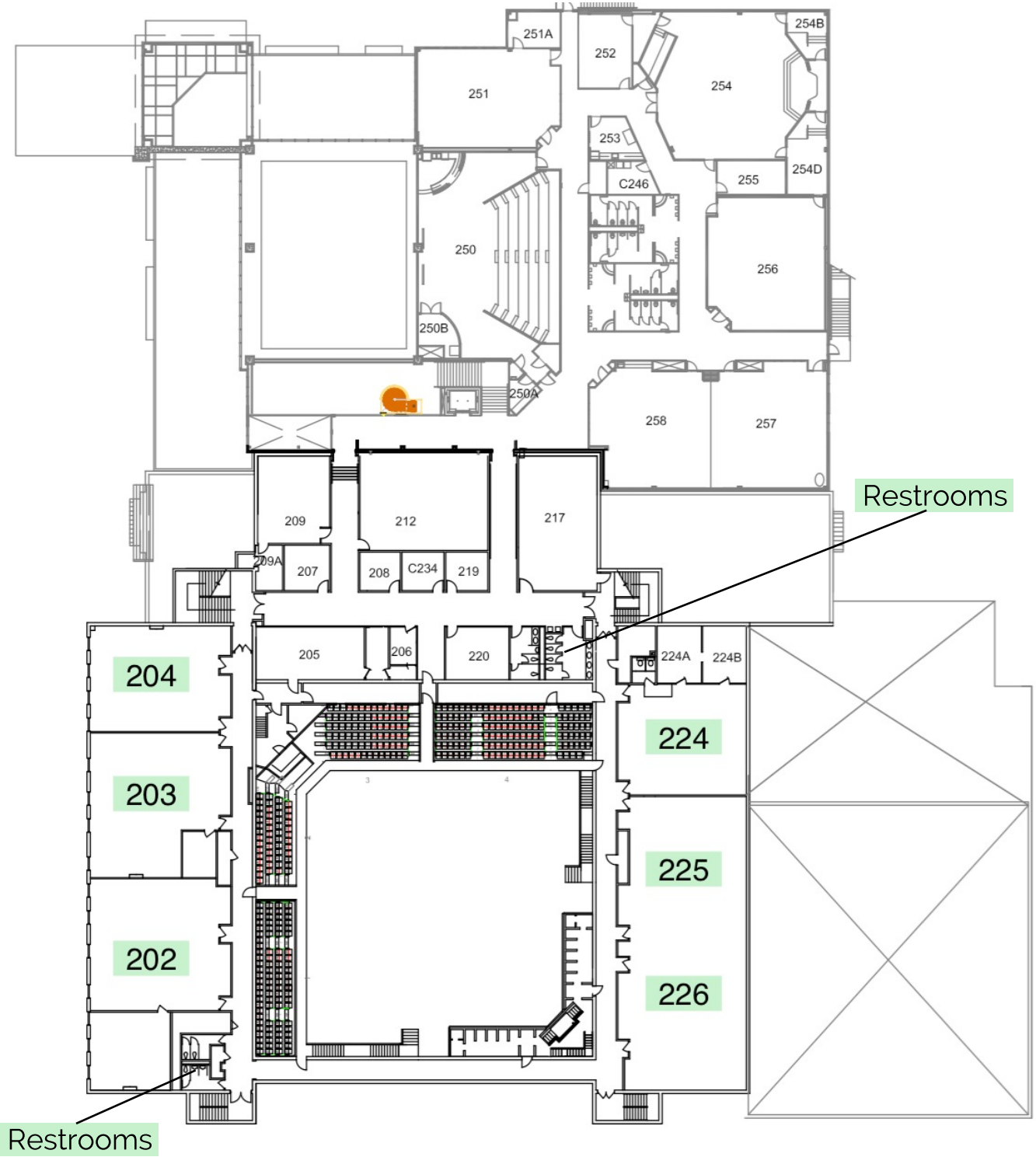

Thursday & Friday Conference Agenda

Thursday, May 29 (Pre-conference)

9:00am - 5:00pm

Ultrasound for Low Resource Healthcare Course - **Rm 203**

Helping Babies Breathe (HBB) - **Rm 101**

Friday, May 30

7:00am - 8:50am Registration/Visit Exhibitors

8:50am - 9:00am Welcome - **Auditorium**

9:00am - 9:50am Plenary 1: "Sticks in a Bundle are Unbreakable" - **Auditorium**

Group Session 1:

Skill Stations (10:00am - 11:15am)	International Medicine (10:00am - 10:50am)	Nonclinical Track (10:00am - 10:50am)
Tropical Medicine Rounds - Simulation - Rm 202	Eye Diseases - Rm 102	Travelers Health & Safety - Rm 101
Suturing Skills - Rm 204	Disability Care in Medical Missions - Auditorium	Disciple Making Movement • - Rm 224
Ultrasound - Rm 203	Social Impact from HIV - Rm 225/226	

Group Session 2:

Skill Stations (11:20am - 12:35pm)	International Medicine (11:00am - 11:50am)	Nonclinical Track (11:00am - 11:50am)
Tropical Medicine Rounds - Simulation - Rm 202	Common Diseases in Uncommon Places - Rm 225/226	Preparing to Go - Rm 224
Suturing Skills - Rm 204	Working with an Interpreter in the Clinical Setting - Rm 101	Medical Missions for Non- Clinicians - Rm 103
Ultrasound - Rm 203		

11:50am - 1:30pm Lunch/Hunger Simulation ** - **Rm 225/226**

Visit Exhibitors/Posters

Group Session 3:

Skill Stations (1:30pm - 2:45pm)	International Medicine (1:30pm - 2:20pm)	Nonclinical Track (1:30pm - 2:20pm)
Tropical Medicine Rounds - Simulation - Rm 202	Eye Diseases - Rm 102	Travelers Health & Safety - Rm 101
Suturing Skills - Rm 204	Disability Care in Medical Missions - Auditorium	Disciple Making Movement • - Rm 224
Ultrasound - Rm 203	Social Impact from HIV - Rm 225/226	

* Faith-Based

** Pre-registration required

Friday Conference Agenda Continued

Group Session 4:

Skill Stations (2:50pm - 4:05pm)	International Medicine (2:30pm - 3:20pm)	Nonclinical Track (2:30pm - 3:20pm)
Tropical Medicine Rounds - Simulation - Rm 202	Overview of Leading Tropical Diseases - Rm 101	Family on the Field - Rm 102
Ultrasound - Rm 203	Overview of Common Pediatric Diseases in Developing Countries - Rm 225/226	Working with an Interpreter - Rm 224
Community Health Survey (non-clinical professionals welcomed) - Rm 204		

Group Session 5:

	Skill Stations Continued	International Medicine (3:30pm - 4:20pm)	Nonclinical Track (3:30pm - 4:20pm)
		Common Diseases in Uncommon Places - Rm 225/226	Preparing to Go - Rm 224
		Working with an Interpreter in the Clinical Setting - Rm 101	Medical Missions for Non- Clinicians - Rm 103

Group Session 6:

Skill Stations (4:10pm - 5:25pm)	International Medicine (4:30pm - 5:20pm)	Nonclinical Track (4:30pm - 5:20pm)
Tropical Medicine Rounds - Simulation - Rm 202	Overview of Leading Tropical Diseases - Rm 101	Family on the Field - Rm 102
Ultrasound - Rm 203	Overview of Common Pediatric Diseases in Developing Countries - Rm 225/226	Working with an Interpreter - Rm 224
Community Health Survey (non-clinical professionals welcomed) - Rm 204		

5:30pm - 7:00pm Visit Exhibitors & Posters

Dinner - Fellowship Hall

7:00pm - 8:00pm Optional Faith-Based Worship (No CE available)* - Auditorium

* Faith-Based

** Pre-registration required

Saturday Conference Agenda

Saturday, May 31

7:30am - 8:00am Registration / Visit Exhibitors

Group Session 7:

Skill Stations (8:00am - 8:50am)	International Medicine (8:00am - 8:50am)	Medical Missions Best Practice (8:00am - 8:50am)
Complicated OB - Rm 202	Overview of Diarrheal Diseases Treatment & Management - Auditorium	Managing Clinical Time - Rm 102
Bandaging and Wound Care - Rm 204	Dermatological Diseases - Rm 203	Medical Missions Outcome - Rm 101
Crisis Response Exercises (non-clinical professionals welcomed) - Rm 258	Tropical Fever Evaluation - Rm 225/226	Mission Opportunities for You - Rm 224

Group Session 8:

Skill Stations (9:00am - 9:50am)	International Medicine (9:00am - 9:50am)	Medical Missions Best Practice (9:00am - 9:50am)
Complicated OB - Rm 202	Common Diseases in Uncommon Places - Rm 101	Working with National Partners - Rm 225/226
Bandaging and Wound Care - Rm 204	Overview of Leading Tropical Diseases - Rm 102	Travelers Health & Safety - Rm 224
Crisis Response Exercises (non-clinical professionals welcomed) - Rm 258		

Group Session 9:

Skill Stations (10:00am - 10:50am)	International Medicine (10:00am - 10:50am)	Medical Missions Best Practice (10:00am - 10:50am)
Complicated OB - Rm 202	Overview of Diarrheal Diseases Treatment & Management - Auditorium	Managing Clinical Time - Rm 102
Bandaging and Wound Care - Rm 204	Dermatological Diseases - Rm 203	Medical Missions Outcome - Rm 101
Crises Response Exercises (non-clinical professionals welcomed) - Rm 258	Tropical Fever Evaluation - Rm 225/226	Mission Opportunities for You - Rm 224

11:00am - 11:50am Plenary 2: *"Sticks in a Bundle are Unbreakable"* - Auditorium

11:50am - 12:00pm Closing - Auditorium

* Faith-Based

** Pre-registration required

Save the Date
for the 2015 EMMMC
May 29 - 30, 2015!



The Institute for International Medicine

*Equipping Healthcare
Professionals & Students to
Serve the Forgotten*



INSTITUTE FOR
INTERNATIONAL
MEDICINE

